

PARK LANE

DUBAI HILLS ESTATE

— INTERIORS BY VIDA —

FLOOR PLAN - BUILDING 1A

EMAAR

PARK LANE

DUBAI HILLS ESTATE

— INTERIORS BY VIDA —

1 BEDROOM

TYPE 1 | BUILDING 1A

UNITS 109, 209, 309, 409, 509, 609, 709, 809, 909, 1009, 1109, 1209,
1309, 1409, 1509, 1609, 1709, 1809, 1909, 2009, 2109

SUITE AREA	585.02 SQFT	54.35 SQM
BALCONY AREA	71.8 SQFT	6.67 SQM
TOTAL AREA	656.81 SQFT	61.02 SQM



KEY SECTION

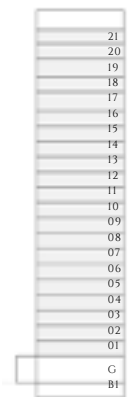

BUILDING 1A

KEY PLAN

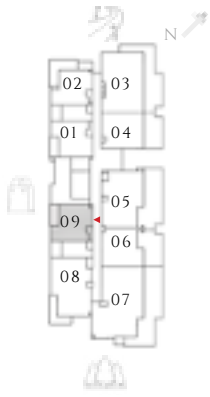

LEVEL 01

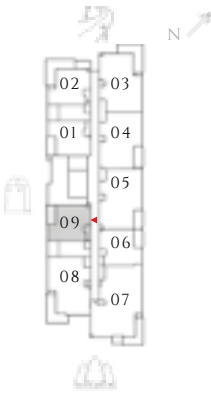

TYPICAL FLOORS (LEVEL02 - 17)

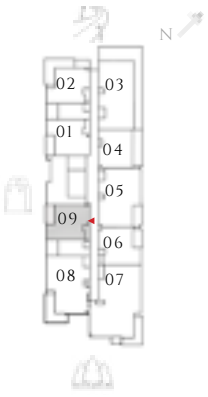

TIER 01 (LEVEL- 18)

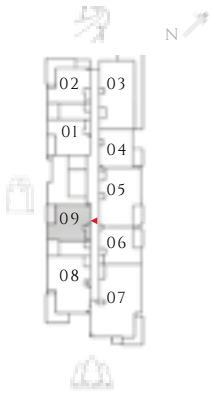

TIER 02 (LEVEL- 19)

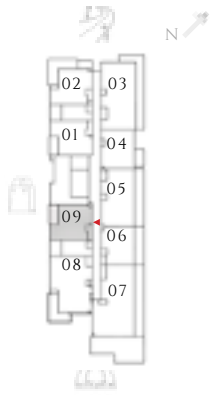

TIER 03 (LEVEL- 20)

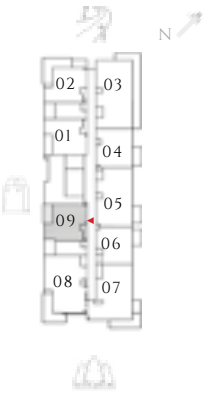

TIER 04 (LEVEL- 21)

FLOOR PLAN 1. All dimensions are in imperial and metric, and measured from finish to finish excluding construction tolerances. 2. All materials, dimensions, and drawings are approximate only. 3. Information is subject to change without notice, at developer’s absolute discretion. 4. Actual area may vary from the stated area. 5. Drawings not to scale. 6. All images used are for illustrative purposes only and do not represent the actual size, features, specifications, fittings, and furnishings. 7. The developer reserves the right to make revisions / alterations, at it’s absolute discretion, without any liability whatsoever.

PARK LANE

DUBAI HILLS ESTATE

— INTERIORS BY VIDA —

1 BEDROOM

TYPE 1 MIRROR | BUILDING 1A

UNITS 101, 201, 301, 401, 501, 601, 701, 801, 901, 1001, 1101, 1201,
1301, 1401, 1501, 1601, 1701, 1801, 1901, 2001, 2101

SUITE AREA	586.96 SQFT	54.53 SQM
BALCONY AREA	71.47 SQFT	6.64 SQM
TOTAL AREA	658.43 SQFT	61.17 SQM



KEY SECTION

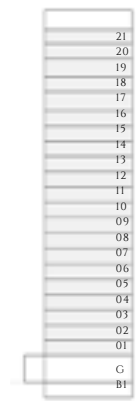

BUILDING 1A

KEY PLAN

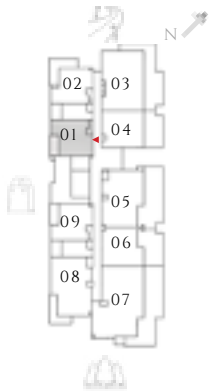

LEVEL 01

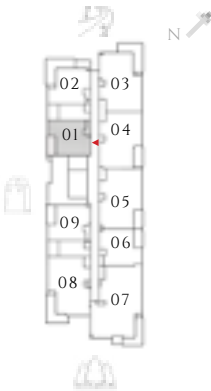

TYPICAL FLOORS (LEVEL02 - 17)

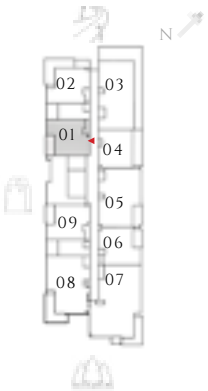

TIER 01 (LEVEL- 18)

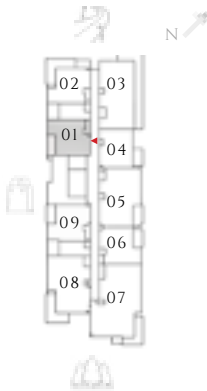

TIER 02 (LEVEL- 19)

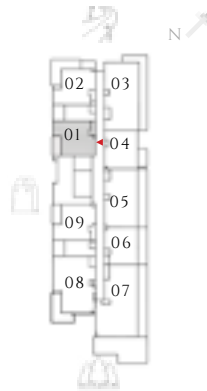

TIER 03 (LEVEL- 20)

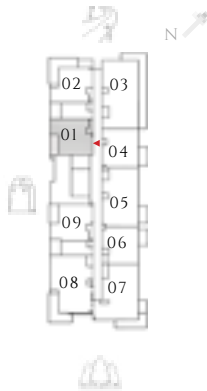

TIER 04 (LEVEL- 21)

FLOOR PLAN 1. All dimensions are in imperial and metric, and measured from finish to finish excluding construction tolerances. 2. All materials, dimensions, and drawings are approximate only. 3. Information is subject to change without notice, at developer’s absolute discretion. 4. Actual area may vary from the stated area. 5. Drawings not to scale. 6. All images used are for illustrative purposes only and do not represent the actual size, features, specifications, fittings, and furnishings. 7. The developer reserves the right to make revisions / alterations, at it’s absolute discretion, without any liability whatsoever.

PARK LANE

DUBAI HILLS ESTATE

— INTERIORS BY VIDA —

1 BEDROOM

TYPE 1 MIRROR | BUILDING 1A

UNITS 1806

SUITE AREA	583.4 SQFT	54.2 SQM
BALCONY AREA	67.49 SQFT	6.27 SQM
TOTAL AREA	650.89 SQFT	60.47 SQM

UNITS 206, 306, 406, 506, 606, 706, 806, 906, 1006, 1106, 1206,
1306, 1406, 1506, 1606, 1706, 1906

SUITE AREA	583.4 SQFT	54.2 SQM
BALCONY AREA	68.14 SQFT	6.33 SQM
TOTAL AREA	651.54 SQFT	60.53 SQM



KEY SECTION

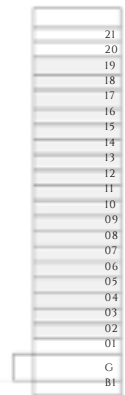

BUILDING 1A

KEY PLAN

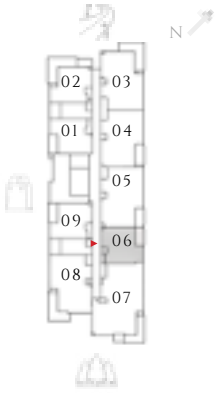

TYPICAL FLOORS (LEVEL02 - 17)

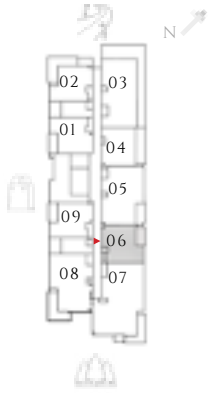

TIER 01 (LEVEL- 18)

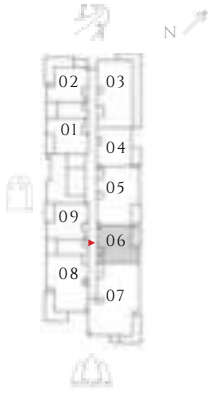

TIER 02 (LEVEL- 19)

FLOOR PLAN 1. All dimensions are in imperial and metric, and measured from finish to finish excluding construction tolerances. 2. All materials, dimensions, and drawings are approximate only. 3. Information is subject to change without notice, at developer’s absolute discretion. 4. Actual area may vary from the stated area. 5. Drawings not to scale. 6. All images used are for illustrative purposes only and do not represent the actual size, features, specifications, fittings, and furnishings. 7. The developer reserves the right to make revisions / alterations, at it’s absolute discretion, without any liability whatsoever.

PARK LANE

DUBAI HILLS ESTATE

— INTERIORS BY VIDA —

1 BEDROOM

TYPE 1A | BUILDING 1A

UNITS 202, 302, 402, 502, 602, 702, 802, 902, 1002, 1102, 1202,
1302, 1402, 1502, 1602, 1702, 1802

SUITE AREA	582 SQFT	54.07 SQM
BALCONY AREA	176.53 SQFT	16.4 SQM
TOTAL AREA	758.53 SQFT	70.47 SQM

UNITS 102, 1902, 2002, 2102

SUITE AREA	582.33 SQFT	54.1 SQM
BALCONY AREA	176.85 SQFT	16.43 SQM
TOTAL AREA	759.18 SQFT	70.53 SQM



KEY SECTION

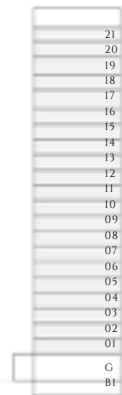

BUILDING 1A

KEY PLAN

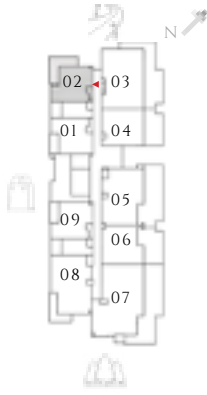

LEVEL 01

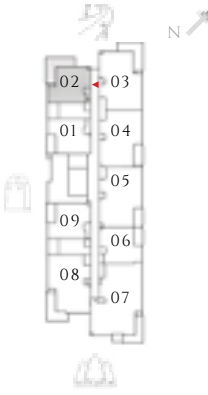

TYPICAL FLOORS (LEVEL02 - 17)

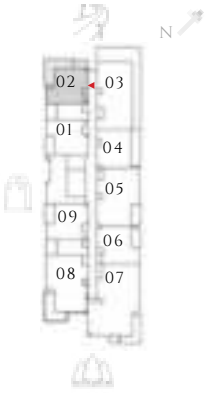

TIER 01 (LEVEL- 18)

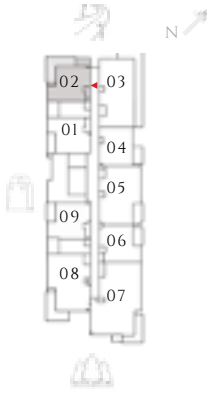

TIER 02 (LEVEL- 19)

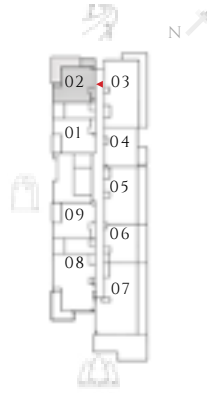

TIER 03 (LEVEL- 20)

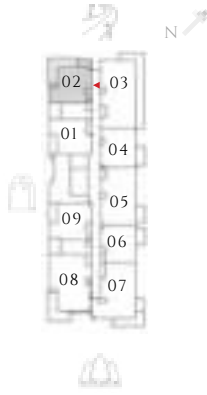

TIER 04 (LEVEL- 21)

FLOOR PLAN 1. All dimensions are in imperial and metric, and measured from finish to finish excluding construction tolerances. 2. All materials, dimensions, and drawings are approximate only. 3. Information is subject to change without notice, at developer's absolute discretion. 4. Actual area may vary from the stated area. 5. Drawings not to scale. 6. All images used are for illustrative purposes only and do not represent the actual size, features, specifications, fittings, and furnishings. 7. The developer reserves the right to make revisions / alterations, at it's absolute discretion, without any liability whatsoever.

PARK LANE

DUBAI HILLS ESTATE

— INTERIORS BY VIDA —

1 BEDROOM

TYPE 1.1 MIRROR| BUILDING 1A

UNITS 106

SUITE AREA	583.3 SQFT	54.19 SQM
BALCONY AREA	385.24 SQFT	35.79 SQM
TOTAL AREA	968.54 SQFT	89.98 SQM

KEY SECTION

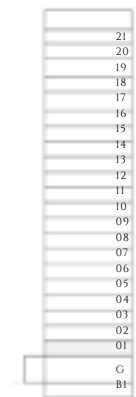

BUILDING 1A

KEY PLAN

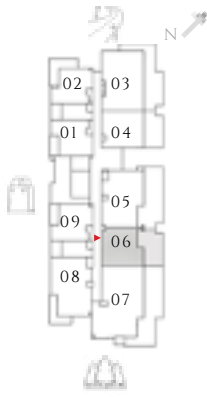

LEVEL 01



FLOOR PLAN 1. All dimensions are in imperial and metric, and measured from finish to finish excluding construction tolerances. 2. All materials, dimensions, and drawings are approximate only. 3. Information is subject to change without notice, at developer’s absolute discretion. 4. Actual area may vary from the stated area. 5. Drawings not to scale. 6. All images used are for illustrative purposes only and do not represent the actual size, features, specifications, fittings, and furnishings. 7. The developer reserves the right to make revisions / alterations, at it’s absolute discretion, without any liability whatsoever.

PARK LANE

DUBAI HILLS ESTATE

— INTERIORS BY VIDA —

1 BEDROOM

TYPE 02 | BUILDING 1A

UNITS 1804

SUITE AREA	592.66 SQFT	55.06 SQM
BALCONY AREA	137.46 SQFT	12.77 SQM
TOTAL AREA	730.12 SQFT	67.83 SQM



KEY SECTION

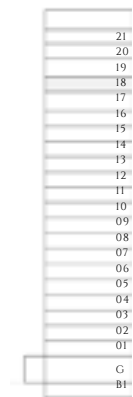

BUILDING 1A

KEY PLAN

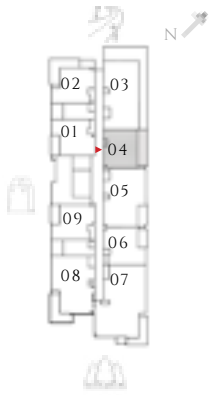

LEVEL 18

FLOOR PLAN 1. All dimensions are in imperial and metric, and measured from finish to finish excluding construction tolerances. 2. All materials, dimensions, and drawings are approximate only. 3. Information is subject to change without notice, at developer's absolute discretion. 4. Actual area may vary from the stated area. 5. Drawings not to scale. 6. All images used are for illustrative purposes only and do not represent the actual size, features, specifications, fittings, and furnishings. 7. The developer reserves the right to make revisions / alterations, at it's absolute discretion, without any liability whatsoever.

PARK LANE

DUBAI HILLS ESTATE

— INTERIORS BY VIDA —

1 BEDROOM

TYPE 2.1 | BUILDING 1A

UNITS 1904

SUITE AREA	592.55 SQFT	55.05 SQM
BALCONY AREA	65.12 SQFT	6.05 SQM
TOTAL AREA	657.67 SQFT	61.1 SQM

UNITS 2004, 2104

SUITE AREA	592.98 SQFT	55.09 SQM
BALCONY AREA	56.83 SQFT	5.28 SQM
TOTAL AREA	649.82 SQFT	60.37 SQM



KEY SECTION

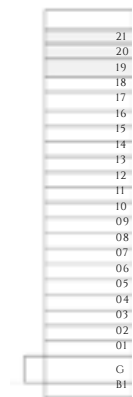

BUILDING 1A

KEY PLAN

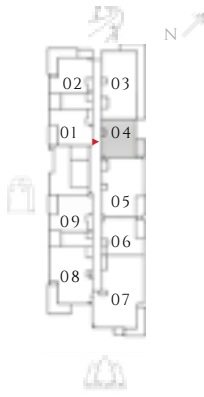

TIER 02 (LEVEL- 19)

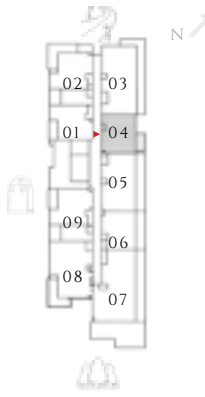

TIER 03 (LEVEL- 20)

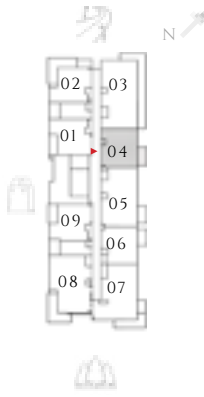

TIER 04 (LEVEL- 21)

FLOOR PLAN 1. All dimensions are in imperial and metric, and measured from finish to finish excluding construction tolerances. 2. All materials, dimensions, and drawings are approximate only. 3. Information is subject to change without notice, at developer's absolute discretion. 4. Actual area may vary from the stated area. 5. Drawings not to scale. 6. All images used are for illustrative purposes only and do not represent the actual size, features, specifications, fittings, and furnishings. 7. The developer reserves the right to make revisions / alterations, at it's absolute discretion, without any liability whatsoever.

PARK LANE

DUBAI HILLS ESTATE

INTERIORS BY VIDA

1 BEDROOM

TYPE 03 | BUILDING 1A

UNITS 2006

SUITE AREA	550.14 SQFT	51.11 SQM
BALCONY AREA	135.95 SQFT	12.63 SQM
TOTAL AREA	686.09 SQFT	63.74 SQM



KEY SECTION

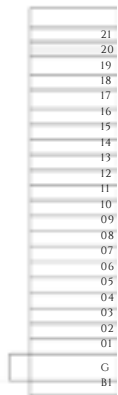

BUILDING 1A

KEY PLAN

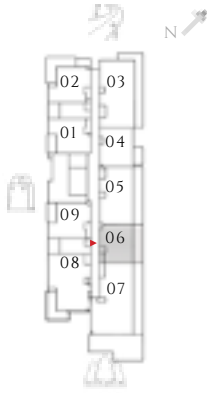

TIER 03 (LEVEL- 20)

FLOOR PLAN 1. All dimensions are in imperial and metric, and measured from finish to finish excluding construction tolerances. 2. All materials, dimensions, and drawings are approximate only. 3. Information is subject to change without notice, at developer’s absolute discretion. 4. Actual area may vary from the stated area. 5. Drawings not to scale. 6. All images used are for illustrative purposes only and do not represent the actual size, features, specifications, fittings, and furnishings. 7. The developer reserves the right to make revisions / alterations, at it’s absolute discretion, without any liability whatsoever.

PARK LANE

DUBAI HILLS ESTATE

— INTERIORS BY VIDA —

1 BEDROOM

TYPE 3.1 | BUILDING 1A

UNITS 2106

SUITE AREA	550.25 SQFT	51.12 SQM
BALCONY AREA	56.73 SQFT	5.27 SQM
TOTAL AREA	606.98 SQFT	56.39 SQM



KEY SECTION

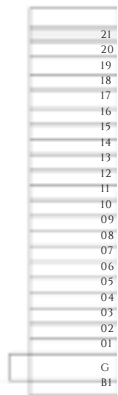

BUILDING 1A

KEY PLAN

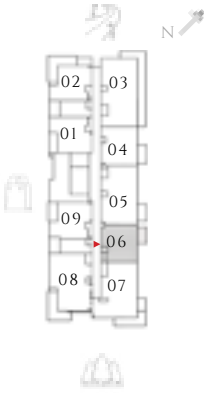

TIER 04 (LEVEL- 21)

FLOOR PLAN 1. All dimensions are in imperial and metric, and measured from finish to finish excluding construction tolerances. 2. All materials, dimensions, and drawings are approximate only. 3. Information is subject to change without notice, at developer's absolute discretion. 4. Actual area may vary from the stated area. 5. Drawings not to scale. 6. All images used are for illustrative purposes only and do not represent the actual size, features, specifications, fittings, and furnishings. 7. The developer reserves the right to make revisions / alterations, at it's absolute discretion, without any liability whatsoever.

PARK LANE

DUBAI HILLS ESTATE

— INTERIORS BY VIDA —

1 BEDROOM

TYPE 04 | BUILDING 1A

UNITS 104

SUITE AREA	558.54 SQFT	51.89 SQM
BALCONY AREA	377.38 SQFT	35.06 SQM
TOTAL AREA	935.92 SQFT	86.95 SQM



KEY SECTION

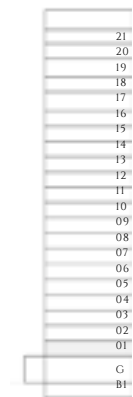

BUILDING 1A

KEY PLAN

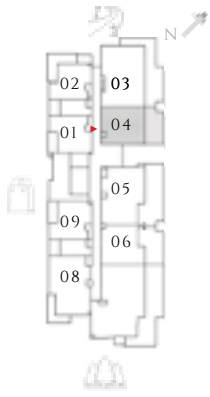

LEVEL 01

FLOOR PLAN 1. All dimensions are in imperial and metric, and measured from finish to finish excluding construction tolerances. 2. All materials, dimensions, and drawings are approximate only. 3. Information is subject to change without notice, at developer’s absolute discretion. 4. Actual area may vary from the stated area. 5. Drawings not to scale. 6. All images used are for illustrative purposes only and do not represent the actual size, features, specifications, fittings, and furnishings. 7. The developer reserves the right to make revisions / alterations, at it’s absolute discretion, without any liability whatsoever.

PARK LANE

DUBAI HILLS ESTATE

— INTERIORS BY VIDA —

2 BEDROOM

TYPE 1 | BUILDING 1A

UNITS 108, 208, 308, 408, 508, 608, 708, 808, 908, 1008, 1108, 1208, 1308, 1408, 1508, 1608, 1708, 1808, 1908

SUITE AREA	960.79 SQFT	89.26 SQM
BALCONY AREA	160.27 SQFT	14.89 SQM
TOTAL AREA	1121.06 SQFT	104.15 SQM

UNITS 203, 303, 403, 503, 603, 703, 803, 903, 1003, 1103, 1203, 1303, 1403, 1503, 1603, 1703

SUITE AREA	958.31 SQFT	89.03 SQM
BALCONY AREA	171.47 SQFT	15.93 SQM
TOTAL AREA	1129.78 SQFT	104.96 SQM



KEY SECTION

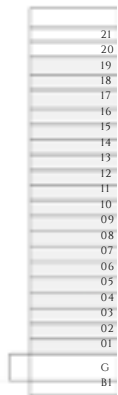

BUILDING 1A

KEY PLAN

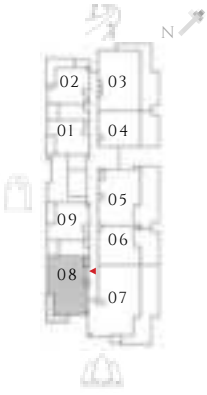

LEVEL 01

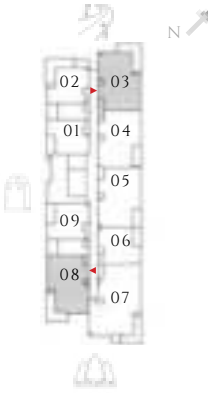

TYPICAL FLOORS (LEVEL02 - 17)

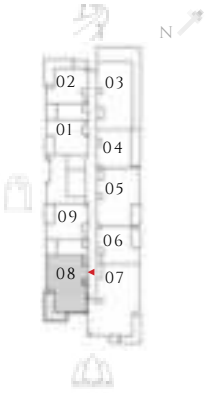

TIER 01 (LEVEL- 18)

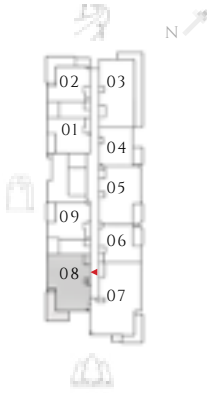

TIER 02 (LEVEL- 19)

FLOOR PLAN 1. All dimensions are in imperial and metric, and measured from finish to finish excluding construction tolerances. 2. All materials, dimensions, and drawings are approximate only. 3. Information is subject to change without notice, at developer’s absolute discretion. 4. Actual area may vary from the stated area. 5. Drawings not to scale. 6. All images used are for illustrative purposes only and do not represent the actual size, features, specifications, fittings, and furnishings. 7. The developer reserves the right to make revisions / alterations, at it’s absolute discretion, without any liability whatsoever.

PARK LANE

DUBAI HILLS ESTATE

— INTERIORS BY VIDA —

2 BEDROOM

TYPE 1 | BUILDING 1A

UNITS 2008

SUITE AREA	961.65 SQFT	89.34 SQM
BALCONY AREA	161.35 SQFT	14.99 SQM
TOTAL AREA	1123 SQFT	104.33 SQM

UNITS 2108

SUITE AREA	961.76 SQFT	89.35 SQM
BALCONY AREA	160.49 SQFT	14.91 SQM
TOTAL AREA	1122.25 SQFT	104.26 SQM



KEY SECTION

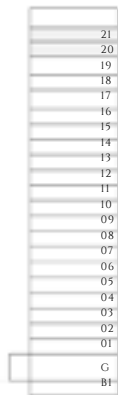

BUILDING 1A

KEY PLAN

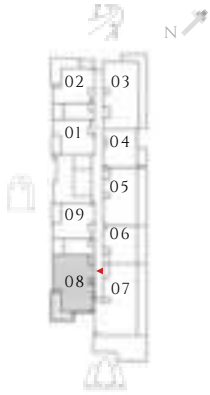

TIER 03 LEVEL 20

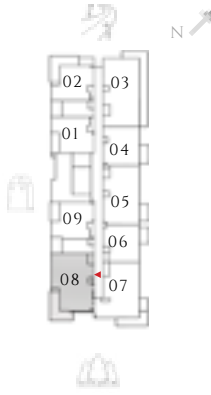

TIER 04 (LEVEL- 21)

FLOOR PLAN 1. All dimensions are in imperial and metric, and measured from finish to finish excluding construction tolerances. 2. All materials, dimensions, and drawings are approximate only. 3. Information is subject to change without notice, at developer’s absolute discretion. 4. Actual area may vary from the stated area. 5. Drawings not to scale. 6. All images used are for illustrative purposes only and do not represent the actual size, features, specifications, fittings, and furnishings. 7. The developer reserves the right to make revisions / alterations, at it’s absolute discretion, without any liability whatsoever.

PARK LANE

DUBAI HILLS ESTATE

— INTERIORS BY VIDA —

2 BEDROOM

TYPE 1.1 | BUILDING 1A

UNIT 103

SUITE AREA	960.14 SQFT	89.2 SQM
BALCONY AREA	732.27 SQFT	68.03 SQM
TOTAL AREA	1692.41 SQFT	157.23 SQM



KEY SECTION

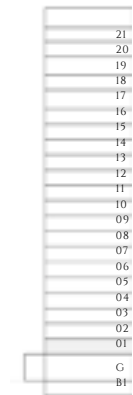

BUILDING 1A

KEY PLAN

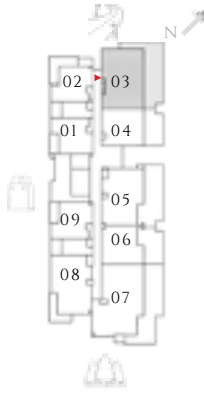

LEVEL 01

FLOOR PLAN 1. All dimensions are in imperial and metric, and measured from finish to finish excluding construction tolerances. 2. All materials, dimensions, and drawings are approximate only. 3. Information is subject to change without notice, at developer's absolute discretion. 4. Actual area may vary from the stated area. 5. Drawings not to scale. 6. All images used are for illustrative purposes only and do not represent the actual size, features, specifications, fittings, and furnishings. 7. The developer reserves the right to make revisions / alterations, at it's absolute discretion, without any liability whatsoever.

PARK LANE

DUBAI HILLS ESTATE

— INTERIORS BY VIDA —

2 BEDROOM

TYPE 1 A | BUILDING 1A

UNITS 204, 304, 404, 504, 604, 704, 804, 904, 1004, 1104, 1204,
1304, 1404, 1504, 1604, 1704

SUITE AREA	963.15 SQFT	89.48 SQM
BALCONY AREA	73.41 SQFT	6.82 SQM
TOTAL AREA	1036.56 SQFT	96.3 SQM

UNITS 205, 305, 405, 505, 605, 705, 805, 905, 1005, 1105, 1205,
1305, 1405, 1505, 1605, 1705, 1905

SUITE AREA	963.91 SQFT	89.55 SQM
BALCONY AREA	76.32 SQFT	7.09 SQM
TOTAL AREA	1040.22 SQFT	96.64 SQM



KEY SECTION

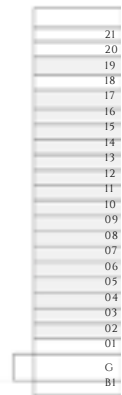

BUILDING 1A

KEY PLAN

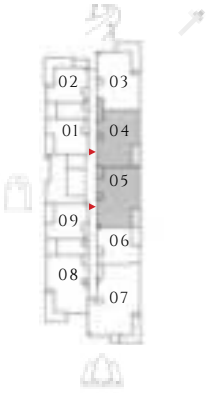

TYPICAL FLOOR (LEVEL 02-17)

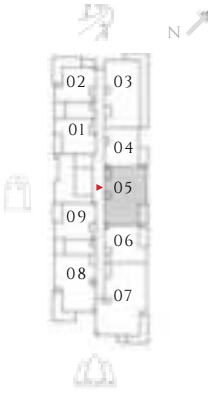

TIER 02 (LEVEL- 19)

FLOOR PLAN 1. All dimensions are in imperial and metric, and measured from finish to finish excluding construction tolerances. 2. All materials, dimensions, and drawings are approximate only. 3. Information is subject to change without notice, at developer’s absolute discretion. 4. Actual area may vary from the stated area. 5. Drawings not to scale. 6. All images used are for illustrative purposes only and do not represent the actual size, features, specifications, fittings, and furnishings. 7. The developer reserves the right to make revisions / alterations, at it’s absolute discretion, without any liability whatsoever.

PARK LANE

DUBAI HILLS ESTATE

— INTERIORS BY VIDA —

2 BEDROOM

TYPE 1 A | BUILDING 1A

UNITS 1805

SUITE AREA	963.59 SQFT	89.52 SQM
BALCONY AREA	78.15 SQFT	7.26 SQM
TOTAL AREA	1041.73 SQFT	96.78 SQM



KEY SECTION

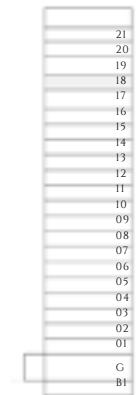

BUILDING 1A

KEY PLAN

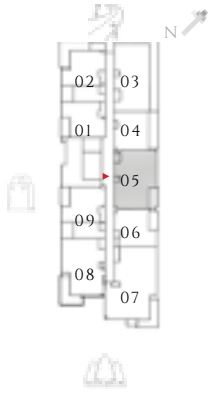

TIER 01 (LEVEL- 18)

FLOOR PLAN 1. All dimensions are in imperial and metric, and measured from finish to finish excluding construction tolerances. 2. All materials, dimensions, and drawings are approximate only. 3. Information is subject to change without notice, at developer’s absolute discretion. 4. Actual area may vary from the stated area. 5. Drawings not to scale. 6. All images used are for illustrative purposes only and do not represent the actual size, features, specifications, fittings, and furnishings. 7. The developer reserves the right to make revisions / alterations, at it’s absolute discretion, without any liability whatsoever.

PARK LANE

DUBAI HILLS ESTATE

— INTERIORS BY VIDA —

2 BEDROOM

TYPE 1A.1 | BUILDING 1A

UNITS 105

SUITE AREA	962.94 SQFT	89.46 SQM
BALCONY AREA	611.82 SQFT	56.84 SQM
TOTAL AREA	1574.76 SQFT	146.3 SQM

KEY SECTION

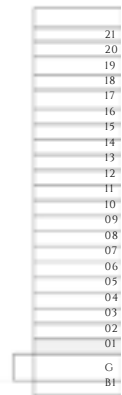

BUILDING 1A

KEY PLAN

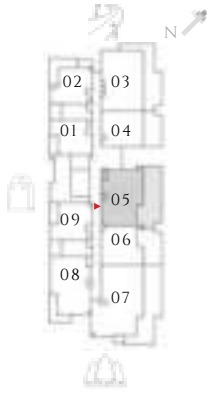

LEVEL 01



FLOOR PLAN 1. All dimensions are in imperial and metric, and measured from finish to finish excluding construction tolerances. 2. All materials, dimensions, and drawings are approximate only. 3. Information is subject to change without notice, at developer’s absolute discretion. 4. Actual area may vary from the stated area. 5. Drawings not to scale. 6. All images used are for illustrative purposes only and do not represent the actual size, features, specifications, fittings, and furnishings. 7. The developer reserves the right to make revisions / alterations, at it’s absolute discretion, without any liability whatsoever.

PARK LANE

DUBAI HILLS ESTATE

INTERIORS BY VIDA

2 BEDROOM

TYPE 2 | BUILDING 1A

UNIT 1803

SUITE AREA	977.04 SQFT	90.77 SQM
BALCONY AREA	527.65 SQFT	49.02 SQM
TOTAL AREA	1504.69 SQFT	139.79 SQM



KEY SECTION

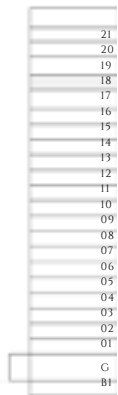

BUILDING 1A

KEY PLAN

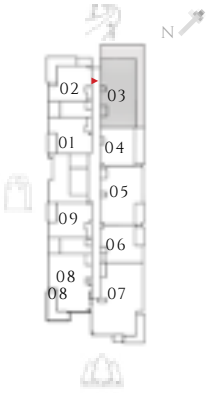

LEVEL 18

FLOOR PLAN 1. All dimensions are in imperial and metric, and measured from finish to finish excluding construction tolerances. 2. All materials, dimensions, and drawings are approximate only. 3. Information is subject to change without notice, at developer's absolute discretion. 4. Actual area may vary from the stated area. 5. Drawings not to scale. 6. All images used are for illustrative purposes only and do not represent the actual size, features, specifications, fittings, and furnishings. 7. The developer reserves the right to make revisions / alterations, at it's absolute discretion, without any liability whatsoever.

PARK LANE

DUBAI HILLS ESTATE

— INTERIORS BY VIDA —

2 BEDROOM

TYPE 2.1 | BUILDING 1A

UNITS 1903

SUITE AREA	978.12 SQFT	90.87 SQM
BALCONY AREA	330.02 SQFT	30.66 SQM
TOTAL AREA	1308.14 SQFT	121.53 SQM

UNITS 2003, 2103

SUITE AREA	977.47 SQFT	90.81 SQM
BALCONY AREA	330.13 SQFT	30.67 SQM
TOTAL AREA	1307.6 SQFT	121.48 SQM



KEY SECTION

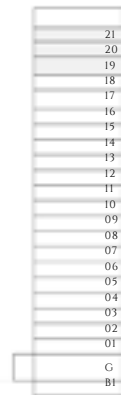

BUILDING 1A

KEY PLAN

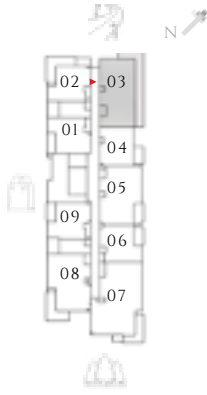

TIER 02 (LEVEL-19)

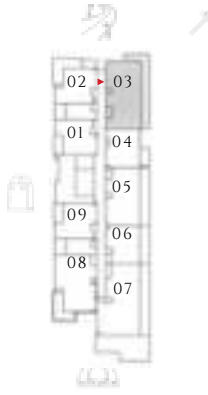

TIER03 (LEVEL-20)

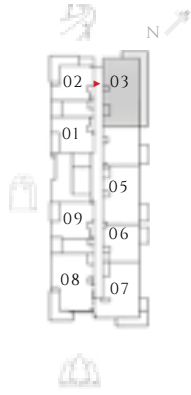

TIER04 (LEVEL-21)

FLOOR PLAN 1. All dimensions are in imperial and metric, and measured from finish to finish excluding construction tolerances. 2. All materials, dimensions, and drawings are approximate only. 3. Information is subject to change without notice, at developer's absolute discretion. 4. Actual area may vary from the stated area. 5. Drawings not to scale. 6. All images used are for illustrative purposes only and do not represent the actual size, features, specifications, fittings, and furnishings. 7. The developer reserves the right to make revisions / alterations, at it's absolute discretion, without any liability whatsoever.

PARK LANE

DUBAI HILLS ESTATE

— INTERIORS BY VIDA —

2 BEDROOM

TYPE 3 | BUILDING 1A

UNITS 2005

SUITE AREA	866.06 SQFT	80.46 SQM
BALCONY AREA	223.46 SQFT	20.76 SQM
TOTAL AREA	1089.52 SQFT	101.22 SQM



KEY SECTION

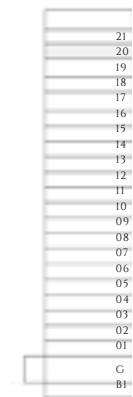

BUILDING 1A

KEY PLAN

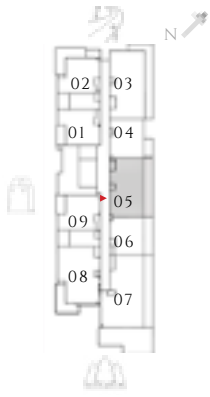

TIER 03 (LEVEL- 20)

FLOOR PLAN 1. All dimensions are in imperial and metric, and measured from finish to finish excluding construction tolerances. 2. All materials, dimensions, and drawings are approximate only. 3. Information is subject to change without notice, at developer’s absolute discretion. 4. Actual area may vary from the stated area. 5. Drawings not to scale. 6. All images used are for illustrative purposes only and do not represent the actual size, features, specifications, fittings, and furnishings. 7. The developer reserves the right to make revisions / alterations, at it’s absolute discretion, without any liability whatsoever.

PARK LANE

DUBAI HILLS ESTATE

— INTERIORS BY VIDA —

2 BEDROOM

TYPE 3.1 | BUILDING 1A

UNIT 2105

SUITE AREA	866.17 SQFT	80.47 SQM
BALCONY AREA	56.83 SQFT	5.28 SQM
TOTAL AREA	923.01 SQFT	85.75 SQM



KEY SECTION

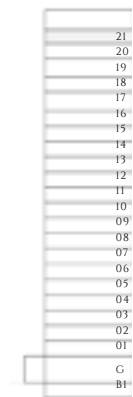

BUILDING 1A

KEY PLAN

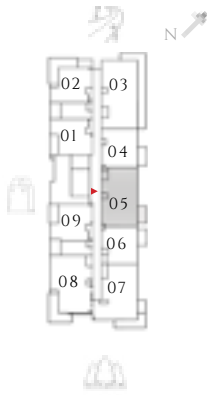

TIER 04 (LEVEL- 21)

FLOOR PLAN 1. All dimensions are in imperial and metric, and measured from finish to finish excluding construction tolerances. 2. All materials, dimensions, and drawings are approximate only. 3. Information is subject to change without notice, at developer’s absolute discretion. 4. Actual area may vary from the stated area. 5. Drawings not to scale. 6. All images used are for illustrative purposes only and do not represent the actual size, features, specifications, fittings, and furnishings. 7. The developer reserves the right to make revisions / alterations, at it’s absolute discretion, without any liability whatsoever.

PARK LANE

DUBAI HILLS ESTATE

— INTERIORS BY VIDA —

2 BEDROOM

TYPE 4 | BUILDING 1A

UNITS 2007

SUITE AREA	923.33 SQFT	85.78 SQM
BALCONY AREA	794.27 SQFT	73.79 SQM
TOTAL AREA	1717.6 SQFT	159.57 SQM



KEY SECTION

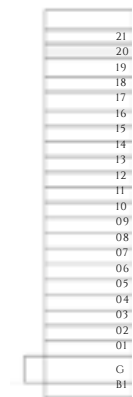

BUILDING 1A

KEY PLAN

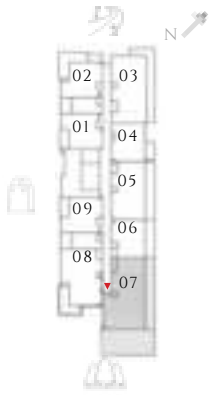

TIER 03 (LEVEL-20)

FLOOR PLAN 1. All dimensions are in imperial and metric, and measured from finish to finish excluding construction tolerances. 2. All materials, dimensions, and drawings are approximate only. 3. Information is subject to change without notice, at developer’s absolute discretion. 4. Actual area may vary from the stated area. 5. Drawings not to scale. 6. All images used are for illustrative purposes only and do not represent the actual size, features, specifications, fittings, and furnishings. 7. The developer reserves the right to make revisions / alterations, at it’s absolute discretion, without any liability whatsoever.

PARK LANE

DUBAI HILLS ESTATE

— INTERIORS BY VIDA —

2 BEDROOM

TYPE 4.1 | BUILDING 1A

UNIT 2107

SUITE AREA	922.36 SQFT	85.69 SQM
BALCONY AREA	134.33 SQFT	12.48 SQM
TOTAL AREA	1056.69 SQFT	98.17 SQM



KEY SECTION

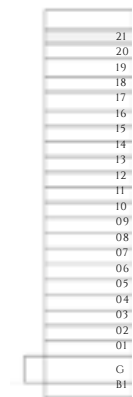

BUILDING 1A

KEY PLAN

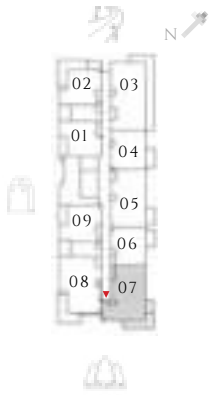

TIER 04 (LEVEL- 21)

FLOOR PLAN 1. All dimensions are in imperial and metric, and measured from finish to finish excluding construction tolerances. 2. All materials, dimensions, and drawings are approximate only. 3. Information is subject to change without notice, at developer's absolute discretion. 4. Actual area may vary from the stated area. 5. Drawings not to scale. 6. All images used are for illustrative purposes only and do not represent the actual size, features, specifications, fittings, and furnishings. 7. The developer reserves the right to make revisions / alterations, at it's absolute discretion, without any liability whatsoever.

PARK LANE

DUBAI HILLS ESTATE

— INTERIORS BY VIDA —

3 BEDROOM

TYPE 1 | BUILDING 1A

UNITS 207, 307, 407, 507, 607, 707, 807, 907, 1007, 1107, 1207, 1307, 1407, 1507, 1607, 1707, 1807, 1907

SUITE AREA	1368.74 SQFT	127.16 SQM
BALCONY AREA	154.68 SQFT	14.37 SQM
TOTAL AREA	1523.42 SQFT	141.53 SQM



KEY SECTION

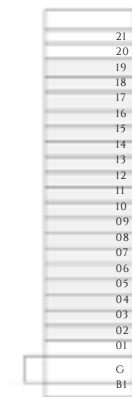

BUILDING 1A

KEY PLAN

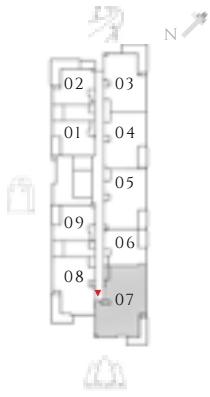

TYPICAL FLOORS (LEVEL02 - 17)

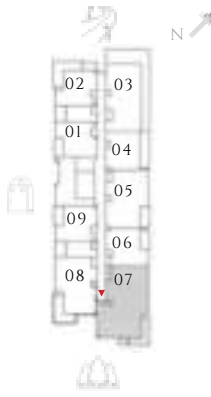

TIER 01 (LEVEL- 18)

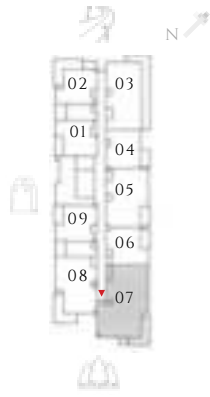

TIER 02 (LEVEL- 19)

FLOOR PLAN 1. All dimensions are in imperial and metric, and measured from finish to finish excluding construction tolerances. 2. All materials, dimensions, and drawings are approximate only. 3. Information is subject to change without notice, at developer's absolute discretion. 4. Actual area may vary from the stated area. 5. Drawings not to scale. 6. All images used are for illustrative purposes only and do not represent the actual size, features, specifications, fittings, and furnishings. 7. The developer reserves the right to make revisions / alterations, at it's absolute discretion, without any liability whatsoever.

PARK LANE

DUBAI HILLS ESTATE

— INTERIORS BY VIDA —

3 BEDROOM

TYPE 1.1 | BUILDING 1A

UNIT 107

SUITE AREA	1368.74 SQFT	127.16 SQM
BALCONY AREA	760.79 SQFT	70.68 SQM
TOTAL AREA	2129.53 SQFT	197.84 SQFT



KEY SECTION

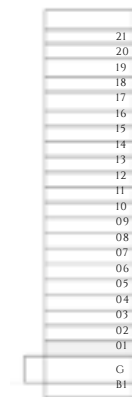

BUILDING 1A

KEY PLAN

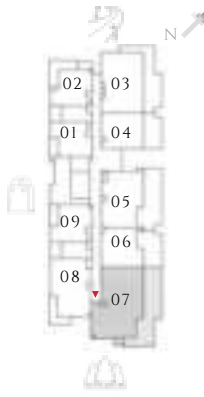

LEVEL 01

FLOOR PLAN 1. All dimensions are in imperial and metric, and measured from finish to finish excluding construction tolerances. 2. All materials, dimensions, and drawings are approximate only. 3. Information is subject to change without notice, at developer's absolute discretion. 4. Actual area may vary from the stated area. 5. Drawings not to scale. 6. All images used are for illustrative purposes only and do not represent the actual size, features, specifications, fittings, and furnishings. 7. The developer reserves the right to make revisions / alterations, at it's absolute discretion, without any liability whatsoever.

PARK LANE

DUBAI HILLS ESTATE

— INTERIORS BY VIDA —

FLOOR PLAN - BUILDING 1B

EMAAR

PARK LANE

DUBAI HILLS ESTATE

INTERIORS BY VIDA

1 BEDROOM

TYPE 1 | BUILDING 1B

UNITS 209, 309, 409, 509, 609, 709, 809, 909, 1009, 1109, 1209, 1309, 1409,
1509, 1609, 1709, 1809, 1909, 2009, 2109

SUITE AREA	585.02 SQFT	54.35 SQM
BALCONY AREA	71.8 SQFT	6.67 SQM
TOTAL AREA	656.81 SQFT	61.02 SQM

UNITS 107

SUITE AREA	585.56 SQFT	54.4 SQM
BALCONY AREA	71.9 SQFT	6.68 SQM
TOTAL AREA	657.46 SQFT	61.08 SQM



KEY SECTION

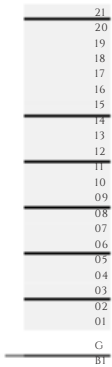

BUILDING 1B

KEY PLAN

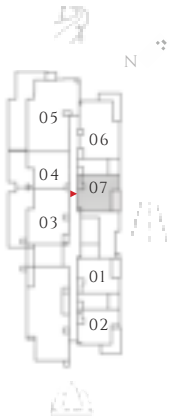

LEVEL 01

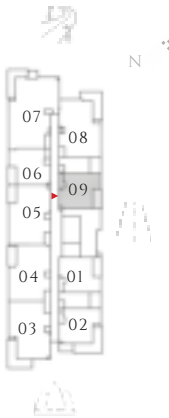

TYPICAL FLOORS (LEVEL02 - 17)

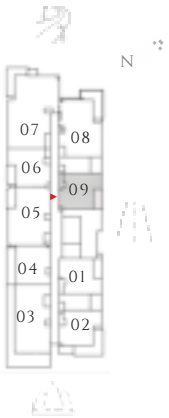

TIER 01 (LEVEL- 18)

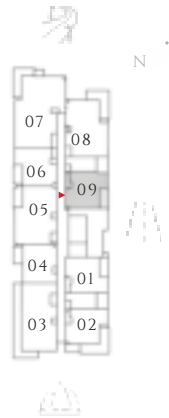

TIER 02 (LEVEL- 19)

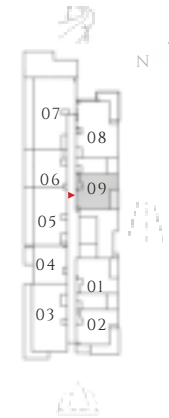

TIER 03 (LEVEL- 20)

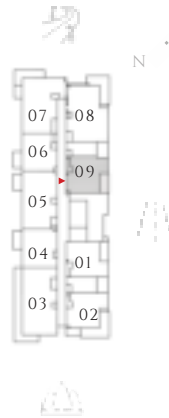

TIER 04 (LEVEL- 21)

FLOOR PLAN 1. All dimensions are in imperial and metric, and measured from finish to finish excluding construction tolerances. 2. All materials, dimensions, and drawings are approximate only. 3. Information is subject to change without notice, at developer's absolute discretion. 4. Actual area may vary from the stated area. 5. Drawings not to scale. 6. All images used are for illustrative purposes only and do not represent the actual size, features, specifications, fittings, and furnishings. 7. The developer reserves the right to make revisions / alterations, at it's absolute discretion, without any liability whatsoever.

PARK LANE

DUBAI HILLS ESTATE

INTERIORS BY VIDA

1 BEDROOM

TYPE 1 MIRROR | BUILDING 1B

UNITS 101, 201, 301, 401, 501, 601, 701, 801, 901, 1001, 1101, 1201, 1301, 1401, 1501, 1601, 1701, 1801, 1901, 2001, 2101

SUITE AREA	586.96 SQFT	54.53 SQM
BALCONY AREA	71.47 SQFT	6.64 SQM
TOTAL AREA	658.43 SQFT	61.17 SQM



KEY SECTION

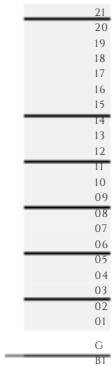

BUILDING 1B

KEY PLAN

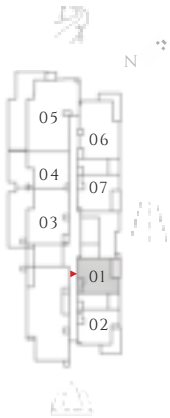

LEVEL 01

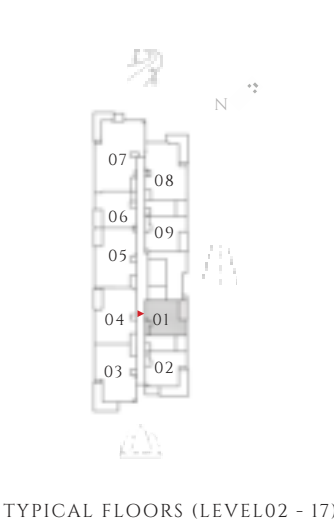

TYPICAL FLOORS (LEVEL02 - 17)

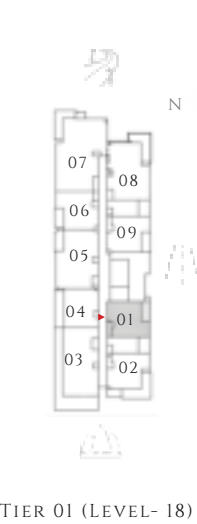

TIER 01 (LEVEL- 18)

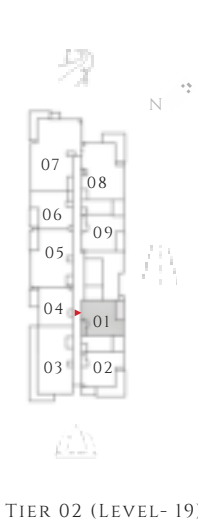

TIER 02 (LEVEL- 19)

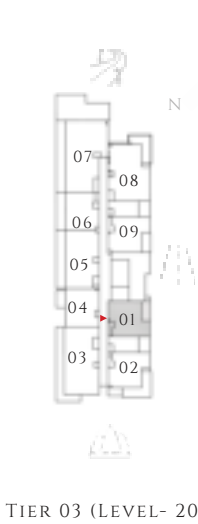

TIER 03 (LEVEL- 20)

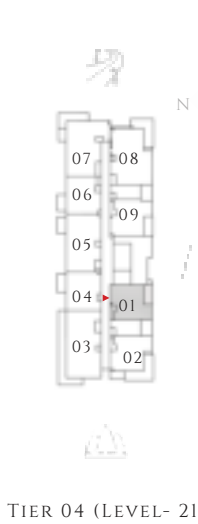

TIER 04 (LEVEL- 21)

FLOOR PLAN 1. All dimensions are in imperial and metric, and measured from finish to finish excluding construction tolerances. 2. All materials, dimensions, and drawings are approximate only. 3. Information is subject to change without notice, at developer's absolute discretion. 4. Actual area may vary from the stated area. 5. Drawings not to scale. 6. All images used are for illustrative purposes only and do not represent the actual size, features, specifications, fittings, and furnishings. 7. The developer reserves the right to make revisions / alterations, at it's absolute discretion, without any liability whatsoever.

PARK LANE

DUBAI HILLS ESTATE

INTERIORS BY VIDA

1 BEDROOM

TYPE 1 MIRROR | BUILDING 1B

UNITS 1806

SUITE AREA	583.4 SQFT	54.2 SQM
BALCONY AREA	67.49 SQFT	6.27 SQM
TOTAL AREA	650.89 SQFT	60.47 SQM

UNITS 206, 306, 406, 506, 606, 706, 806, 906, 1006, 1106, 1206, 1306, 1406, 1506, 1606, 1706, 1906

SUITE AREA	583.4 SQFT	54.2 SQM
BALCONY AREA	68.14 SQFT	6.33 SQM
TOTAL AREA	651.54 SQFT	60.53 SQM



KEY SECTION

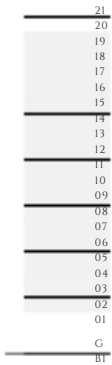

BUILDING 1B

KEY PLAN

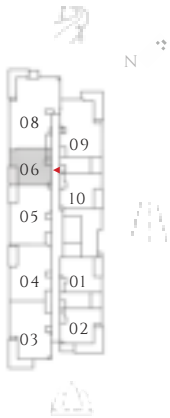

TYPICAL FLOORS (LEVEL 02 - 17)

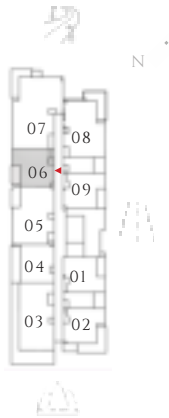

TIER 01 (LEVEL- 18)

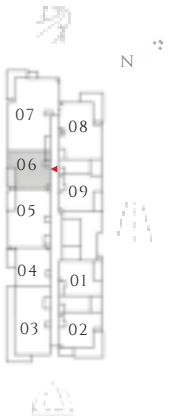

TIER 02 (LEVEL- 19)

FLOOR PLAN 1. All dimensions are in imperial and metric, and measured from finish to finish excluding construction tolerances. 2. All materials, dimensions, and drawings are approximate only. 3. Information is subject to change without notice, at developer’s absolute discretion. 4. Actual area may vary from the stated area. 5. Drawings not to scale. 6. All images used are for illustrative purposes only and do not represent the actual size, features, specifications, fittings, and furnishings. 7. The developer reserves the right to make revisions / alterations, at it’s absolute discretion, without any liability whatsoever.

PARK LANE

DUBAI HILLS ESTATE

INTERIORS BY VIDA

1 BEDROOM

TYPE 1A | BUILDING 1B

UNITS 202, 302, 402, 502, 602, 702, 802, 902, 1002, 1102, 1202, 1302, 1402, 1502, 1602, 1802

SUITE AREA	582 SQFT	54.07 SQM
BALCONY AREA	176.53 SQFT	16.4 SQM
TOTAL AREA	758.53 SQFT	70.47 SQM

UNITS 102, 1702, 1902, 2002, 2102

SUITE AREA	582.44 SQFT	54.11 SQM
BALCONY AREA	176.64 SQFT	16.41 SQM
TOTAL AREA	759.07 SQFT	70.52 SQM



KEY SECTION

KEY PLAN

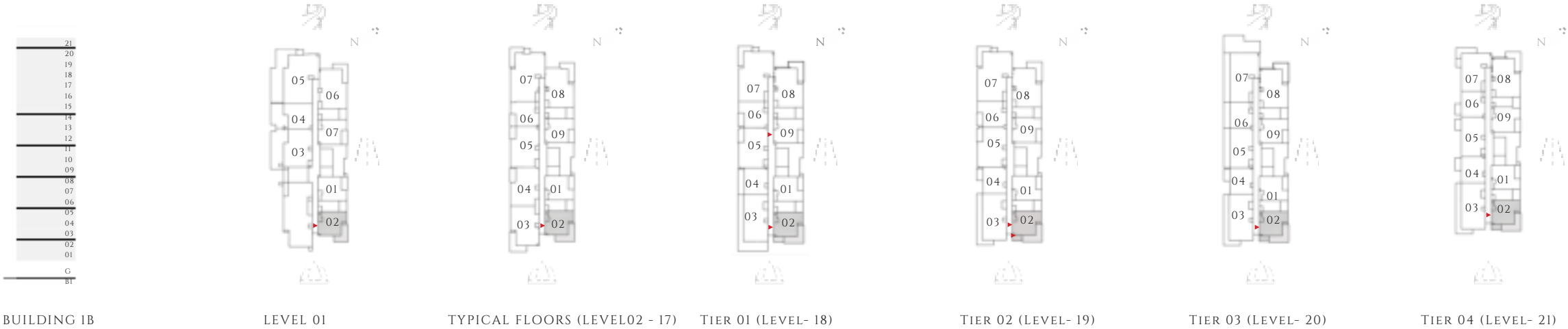

FLOOR PLAN 1. All dimensions are in imperial and metric, and measured from finish to finish excluding construction tolerances. 2. All materials, dimensions, and drawings are approximate only. 3. Information is subject to change without notice, at developer's absolute discretion. 4. Actual area may vary from the stated area. 5. Drawings not to scale. 6. All images used are for illustrative purposes only and do not represent the actual size, features, specifications, fittings, and furnishings. 7. The developer reserves the right to make revisions / alterations, at it's absolute discretion, without any liability whatsoever.

PARK LANE

DUBAI HILLS ESTATE

INTERIORS BY VIDA

1 BEDROOM

TYPE 1.1 MIRROR| BUILDING 1B

UNITS 104

SUITE AREA	583.3 SQFT	54.19 SQM
BALCONY AREA	382.01 SQFT	35.49 SQM
TOTAL AREA	965.31 SQFT	89.68 SQM

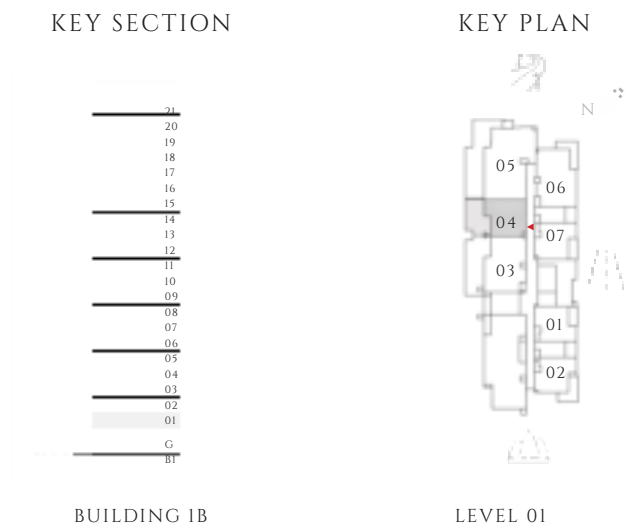

FLOOR PLAN 1. All dimensions are in imperial and metric, and measured from finish to finish excluding construction tolerances. 2. All materials, dimensions, and drawings are approximate only. 3. Information is subject to change without notice, at developer's absolute discretion. 4. Actual area may vary from the stated area. 5. Drawings not to scale. 6. All images used are for illustrative purposes only and do not represent the actual size, features, specifications, fittings, and furnishings. 7. The developer reserves the right to make revisions / alterations, at it's absolute discretion, without any liability whatsoever.

PARK LANE

DUBAI HILLS ESTATE

INTERIORS BY VIDA

1 BEDROOM

TYPE 02 | BUILDING 1B

UNITS 1804

SUITE AREA	592.66 SQFT	55.06 SQM
BALCONY AREA	137.46 SQFT	12.77 SQM
TOTAL AREA	730.12 SQFT	67.83 SQM



KEY SECTION

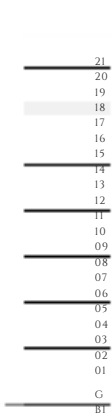

BUILDING 1B

KEY PLAN

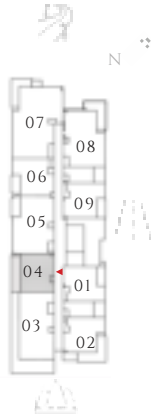

LEVEL 18

FLOOR PLAN 1. All dimensions are in imperial and metric, and measured from finish to finish excluding construction tolerances. 2. All materials, dimensions, and drawings are approximate only. 3. Information is subject to change without notice, at developer's absolute discretion. 4. Actual area may vary from the stated area. 5. Drawings not to scale. 6. All images used are for illustrative purposes only and do not represent the actual size, features, specifications, fittings, and furnishings. 7. The developer reserves the right to make revisions / alterations, at it's absolute discretion, without any liability whatsoever.

PARK LANE

DUBAI HILLS ESTATE

INTERIORS BY VIDA

1 BEDROOM

TYPE 2.1 | BUILDING 1B

UNITS 1904

SUITE AREA	592.55 SQFT	55.05 SQM
BALCONY AREA	65.12 SQFT	6.05 SQM
TOTAL AREA	657.67 SQFT	61.1 SQM

UNITS 2004, 2104

SUITE AREA	593.09 SQFT	55.1 SQM
BALCONY AREA	56.83 SQFT	5.28 SQM
TOTAL AREA	649.92 SQFT	60.38 SQM



KEY SECTION

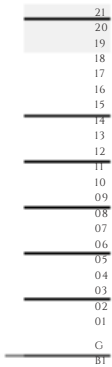

BUILDING 1B

KEY PLAN

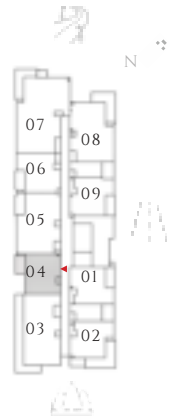

TIER 02 (LEVEL- 19)

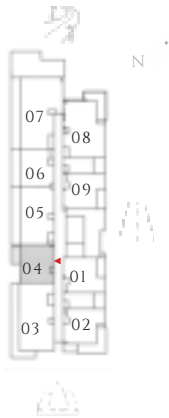

TIER 03 (LEVEL- 20)

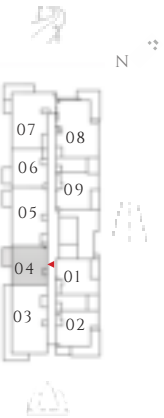

TIER 04 (LEVEL- 21)

FLOOR PLAN 1. All dimensions are in imperial and metric, and measured from finish to finish excluding construction tolerances. 2. All materials, dimensions, and drawings are approximate only. 3. Information is subject to change without notice, at developer's absolute discretion. 4. Actual area may vary from the stated area. 5. Drawings not to scale. 6. All images used are for illustrative purposes only and do not represent the actual size, features, specifications, fittings, and furnishings. 7. The developer reserves the right to make revisions / alterations, at it's absolute discretion, without any liability whatsoever.

PARK LANE

DUBAI HILLS ESTATE

INTERIORS BY VIDA

1 BEDROOM

TYPE 03 | BUILDING 1A

UNITS 2006

SUITE AREA	550.14 SQFT	51.11 SQM
BALCONY AREA	135.95 SQFT	12.63 SQM
TOTAL AREA	686.09 SQFT	63.74 SQM



KEY SECTION

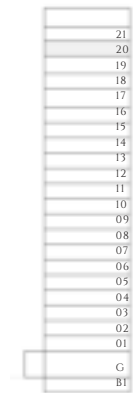

BUILDING 1B

KEY PLAN

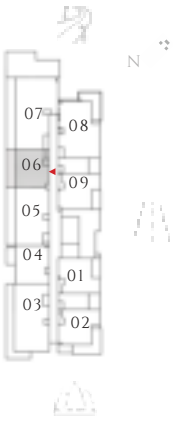

TIER 03 (LEVEL- 20)

FLOOR PLAN 1. All dimensions are in imperial and metric, and measured from finish to finish excluding construction tolerances. 2. All materials, dimensions, and drawings are approximate only. 3. Information is subject to change without notice, at developer's absolute discretion. 4. Actual area may vary from the stated area. 5. Drawings not to scale. 6. All images used are for illustrative purposes only and do not represent the actual size, features, specifications, fittings, and furnishings. 7. The developer reserves the right to make revisions / alterations, at it's absolute discretion, without any liability whatsoever.

PARK LANE

DUBAI HILLS ESTATE

INTERIORS BY VIDA

1 BEDROOM

TYPE 3.1 | BUILDING 1B

UNITS 2106

SUITE AREA	550.25 SQFT	51.12 SQM
BALCONY AREA	56.73 SQFT	5.27 SQM
TOTAL AREA	606.98 SQFT	56.39 SQM



KEY SECTION

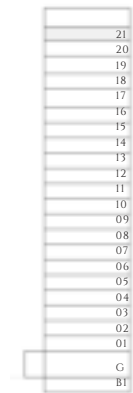

BUILDING 1B

KEY PLAN

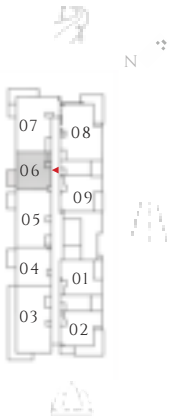

TIER 04 (LEVEL- 21)

FLOOR PLAN 1. All dimensions are in imperial and metric, and measured from finish to finish excluding construction tolerances. 2. All materials, dimensions, and drawings are approximate only. 3. Information is subject to change without notice, at developer's absolute discretion. 4. Actual area may vary from the stated area. 5. Drawings not to scale. 6. All images used are for illustrative purposes only and do not represent the actual size, features, specifications, fittings, and furnishings. 7. The developer reserves the right to make revisions / alterations, at it's absolute discretion, without any liability whatsoever.

PARK LANE

DUBAI HILLS ESTATE

INTERIORS BY VIDA

2 BEDROOM

TYPE 1 | BUILDING 1B

UNITS 106, 208, 308, 408, 508, 608, 708, 808, 908, 1008, 1108, 1208, 1308, 1408, 1508, 1608, 1708, 1808, 1908

SUITE AREA	960.79 SQFT	89.26 SQM
BALCONY AREA	160.27 SQFT	14.89 SQM
TOTAL AREA	1121.06 SQFT	104.15 SQM

UNITS 203, 303, 403, 503, 603, 703, 803, 903, 1003, 1103, 1203, 1303, 1403, 1503, 1603, 1703

SUITE AREA	958.74 SQFT	89.07 SQM
BALCONY AREA	171.15 SQFT	15.9 SQM
TOTAL AREA	1129.89 SQFT	104.97 SQM



KEY SECTION

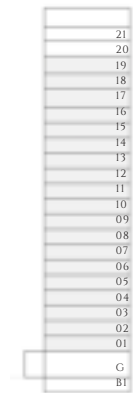

BUILDING 1B

KEY PLAN

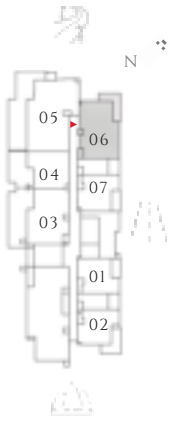

LEVEL 01

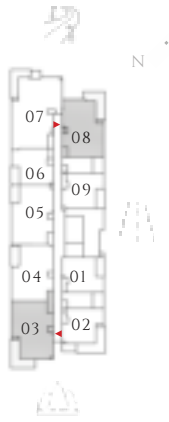

TYPICAL FLOORS (LEVEL02 - 17)

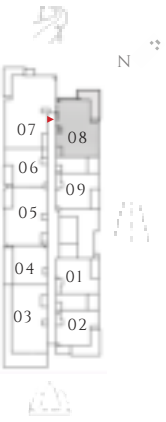

TIER 01 (LEVEL- 18)

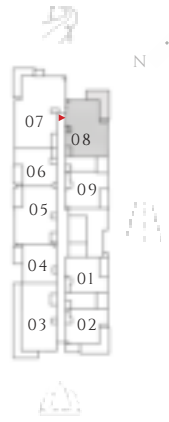

TIER 02 (LEVEL- 19)

FLOOR PLAN 1. All dimensions are in imperial and metric, and measured from finish to finish excluding construction tolerances. 2. All materials, dimensions, and drawings are approximate only. 3. Information is subject to change without notice, at developer's absolute discretion. 4. Actual area may vary from the stated area. 5. Drawings not to scale. 6. All images used are for illustrative purposes only and do not represent the actual size, features, specifications, fittings, and furnishings. 7. The developer reserves the right to make revisions / alterations, at it's absolute discretion, without any liability whatsoever.

PARK LANE

DUBAI HILLS ESTATE

INTERIORS BY VIDA

2 BEDROOM

TYPE 1 | BUILDING 1B

UNITS 2008

SUITE AREA	961.76 SQFT	89.35 SQM
BALCONY AREA	161.35 SQFT	14.99 SQM
TOTAL AREA	1123.11 SQFT	104.34 SQM

UNITS 2108

SUITE AREA	961.76 SQFT	89.35 SQM
BALCONY AREA	160.49 SQFT	14.91 SQM
TOTAL AREA	1122.25 SQFT	104.26 SQM



KEY SECTION

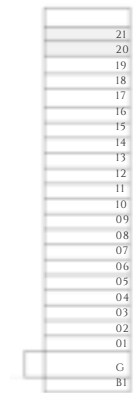

BUILDING 1B

KEY PLAN

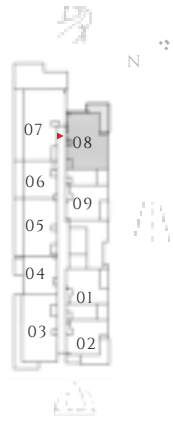

TIER 03 LEVEL 20

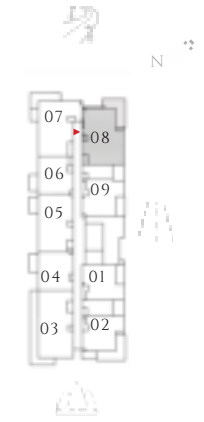

TIER 04 (LEVEL- 21)

FLOOR PLAN 1. All dimensions are in imperial and metric, and measured from finish to finish excluding construction tolerances. 2. All materials, dimensions, and drawings are approximate only. 3. Information is subject to change without notice, at developer’s absolute discretion. 4. Actual area may vary from the stated area. 5. Drawings not to scale. 6. All images used are for illustrative purposes only and do not represent the actual size, features, specifications, fittings, and furnishings. 7. The developer reserves the right to make revisions / alterations, at it’s absolute discretion, without any liability whatsoever.

PARK LANE

DUBAI HILLS ESTATE

INTERIORS BY VIDA

2 BEDROOM

TYPE 1 A | BUILDING 1B

UNITS 204, 304, 404, 504, 604, 704, 804, 904, 1004, 1104, 1204, 1304, 1404, 1504, 1604, 1704

SUITE AREA	963.15 SQFT	89.48 SQM
BALCONY AREA	73.41 SQFT	6.82 SQM
TOTAL AREA	1036.56 SQFT	96.3 SQFT

UNITS 205, 305, 405, 505, 605, 705, 805, 905, 1005, 1105, 1205, 1305, 1405, 1505, 1605, 1705, 1905

SUITE AREA	962.94 SQFT	89.46 SQM
BALCONY AREA	77.5 SQFT	7.2 SQM
TOTAL AREA	1040.44 SQFT	96.66 SQM



KEY SECTION

KEY PLAN

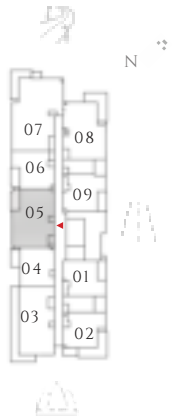
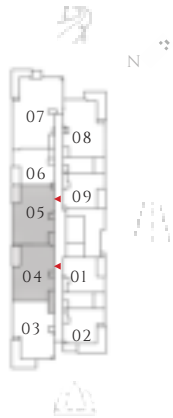
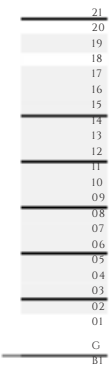

BUILDING 1B

TYPICAL FLOOR (LEVEL 02-17)

TIER 02 (LEVEL- 19)

FLOOR PLAN 1. All dimensions are in imperial and metric, and measured from finish to finish excluding construction tolerances. 2. All materials, dimensions, and drawings are approximate only. 3. Information is subject to change without notice, at developer's absolute discretion. 4. Actual area may vary from the stated area. 5. Drawings not to scale. 6. All images used are for illustrative purposes only and do not represent the actual size, features, specifications, fittings, and furnishings. 7. The developer reserves the right to make revisions / alterations, at it's absolute discretion, without any liability whatsoever.

PARK LANE

DUBAI HILLS ESTATE

INTERIORS BY VIDA

2 BEDROOM

TYPE 1 A | BUILDING 1B

UNITS 1805

SUITE AREA	963.59 SQFT	89.52 SQM
BALCONY AREA	78.15 SQFT	7.26 SQM
TOTAL AREA	1041.73 SQFT	96.78 SQFT



KEY SECTION

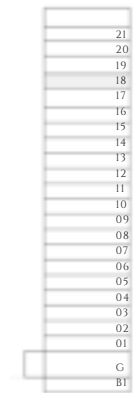

BUILDING 1B

KEY PLAN

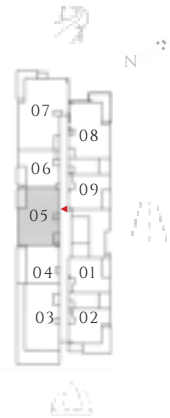

TIER 01 (LEVEL- 18)

FLOOR PLAN 1. All dimensions are in imperial and metric, and measured from finish to finish excluding construction tolerances. 2. All materials, dimensions, and drawings are approximate only. 3. Information is subject to change without notice, at developer’s absolute discretion. 4. Actual area may vary from the stated area. 5. Drawings not to scale. 6. All images used are for illustrative purposes only and do not represent the actual size, features, specifications, fittings, and furnishings. 7. The developer reserves the right to make revisions / alterations, at it’s absolute discretion, without any liability whatsoever.

PARK LANE

DUBAI HILLS ESTATE

INTERIORS BY VIDA

2 BEDROOM

TYPE 1A.1 | BUILDING 1B

UNITS 103

SUITE AREA	962.94 SQFT	89.46 SQM
BALCONY AREA	603.53 SQFT	56.07 SQM
TOTAL AREA	1566.47 SQFT	145.53 SQM

KEY SECTION



BUILDING 1B

KEY PLAN

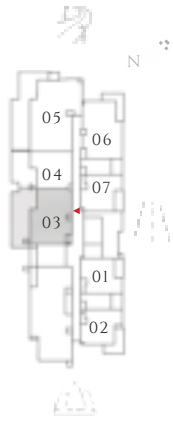

LEVEL 01



FLOOR PLAN 1. All dimensions are in imperial and metric, and measured from finish to finish excluding construction tolerances. 2. All materials, dimensions, and drawings are approximate only. 3. Information is subject to change without notice, at developer's absolute discretion. 4. Actual area may vary from the stated area. 5. Drawings not to scale. 6. All images used are for illustrative purposes only and do not represent the actual size, features, specifications, fittings, and furnishings. 7. The developer reserves the right to make revisions / alterations, at it's absolute discretion, without any liability whatsoever.

PARK LANE

DUBAI HILLS ESTATE

INTERIORS BY VIDA

2 BEDROOM

TYPE 2 | BUILDING 1B

UNIT 1803

SUITE AREA	977.04 SQFT	90.77 SQM
BALCONY AREA	527.65 SQFT	49.02 SQM
TOTAL AREA	1504.69 SQFT	139.79 SQM



KEY SECTION

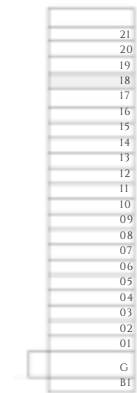

BUILDING 1B

KEY PLAN

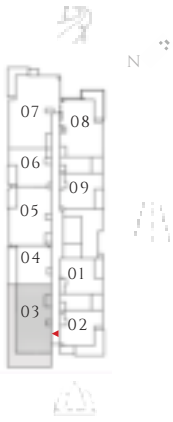

LEVEL 18

FLOOR PLAN 1. All dimensions are in imperial and metric, and measured from finish to finish excluding construction tolerances. 2. All materials, dimensions, and drawings are approximate only. 3. Information is subject to change without notice, at developer's absolute discretion. 4. Actual area may vary from the stated area. 5. Drawings not to scale. 6. All images used are for illustrative purposes only and do not represent the actual size, features, specifications, fittings, and furnishings. 7. The developer reserves the right to make revisions / alterations, at it's absolute discretion, without any liability whatsoever.

PARK LANE

DUBAI HILLS ESTATE

INTERIORS BY VIDA

2 BEDROOM

TYPE 2.1 | BUILDING 1

UNITS 1903, 2003, 2103

SUITE AREA	977.47 SQFT	90.81 SQM
BALCONY AREA	330.13 SQFT	30.67 SQM
TOTAL AREA	1307.6 SQFT	121.48 SQM



KEY SECTION

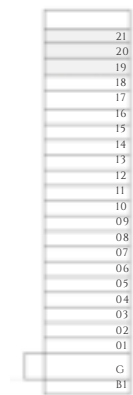

BUILDING 1B

KEY PLAN

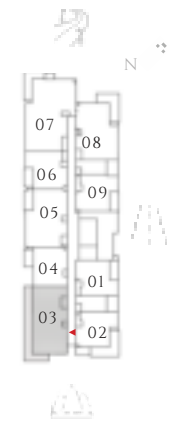

TIER 02 (LEVEL-19)

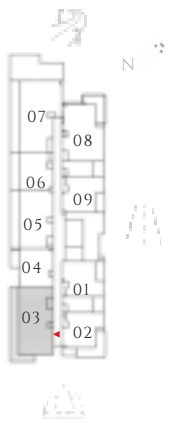

TIER03 (LEVEL-20)

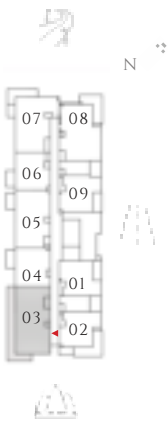

TIER04 (LEVEL-21)

FLOOR PLAN 1. All dimensions are in imperial and metric, and measured from finish to finish excluding construction tolerances. 2. All materials, dimensions, and drawings are approximate only. 3. Information is subject to change without notice, at developer's absolute discretion. 4. Actual area may vary from the stated area. 5. Drawings not to scale. 6. All images used are for illustrative purposes only and do not represent the actual size, features, specifications, fittings, and furnishings. 7. The developer reserves the right to make revisions / alterations, at it's absolute discretion, without any liability whatsoever.

PARK LANE

DUBAI HILLS ESTATE

INTERIORS BY VIDA

2 BEDROOM

TYPE 3 | BUILDING 1B

UNITS 2005

SUITE AREA	866.06 SQFT	80.46 SQM
BALCONY AREA	223.46 SQFT	20.76 SQM
TOTAL AREA	1089.52 SQFT	101.22 SQM



KEY SECTION

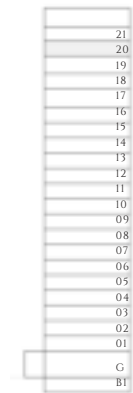

BUILDING 1B

KEY PLAN

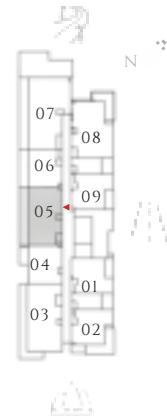

TIER 03 (LEVEL- 20)

FLOOR PLAN 1. All dimensions are in imperial and metric, and measured from finish to finish excluding construction tolerances. 2. All materials, dimensions, and drawings are approximate only. 3. Information is subject to change without notice, at developer’s absolute discretion. 4. Actual area may vary from the stated area. 5. Drawings not to scale. 6. All images used are for illustrative purposes only and do not represent the actual size, features, specifications, fittings, and furnishings. 7. The developer reserves the right to make revisions / alterations, at it’s absolute discretion, without any liability whatsoever.

PARK LANE

DUBAI HILLS ESTATE

INTERIORS BY VIDA

2 BEDROOM

TYPE 3.1 | BUILDING 1B

UNIT 2105

SUITE AREA	866.06 SQFT	80.46 SQM
BALCONY AREA	56.83 SQFT	5.28 SQM
TOTAL AREA	922.9 SQFT	85.74 SQM



KEY SECTION

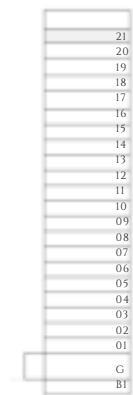

BUILDING 1B

KEY PLAN

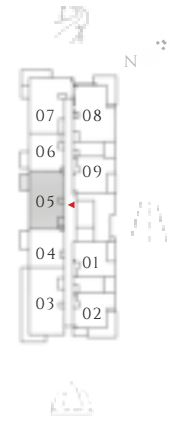

TIER 04 (LEVEL- 21)

FLOOR PLAN 1. All dimensions are in imperial and metric, and measured from finish to finish excluding construction tolerances. 2. All materials, dimensions, and drawings are approximate only. 3. Information is subject to change without notice, at developer’s absolute discretion. 4. Actual area may vary from the stated area. 5. Drawings not to scale. 6. All images used are for illustrative purposes only and do not represent the actual size, features, specifications, fittings, and furnishings. 7. The developer reserves the right to make revisions / alterations, at it’s absolute discretion, without any liability whatsoever.

PARK LANE

DUBAI HILLS ESTATE

INTERIORS BY VIDA

2 BEDROOM

TYPE 4 | BUILDING 1B

UNIT 2007

SUITE AREA	923.54 SQFT	85.8 SQM
BALCONY AREA	794.27 SQFT	73.79 SQM
TOTAL AREA	1717.81 SQFT	159.59 SQM



KEY SECTION

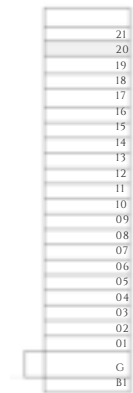

BUILDING 1B

KEY PLAN

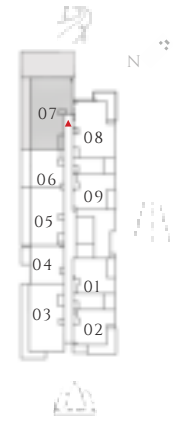

TIER 03 (LEVEL- 20)

FLOOR PLAN 1. All dimensions are in imperial and metric, and measured from finish to finish excluding construction tolerances. 2. All materials, dimensions, and drawings are approximate only. 3. Information is subject to change without notice, at developer's absolute discretion. 4. Actual area may vary from the stated area. 5. Drawings not to scale. 6. All images used are for illustrative purposes only and do not represent the actual size, features, specifications, fittings, and furnishings. 7. The developer reserves the right to make revisions / alterations, at it's absolute discretion, without any liability whatsoever.

PARK LANE

DUBAI HILLS ESTATE

INTERIORS BY VIDA

2 BEDROOM

TYPE 4.1 | BUILDING 1B

UNIT 2107

SUITE AREA	922.79 SQFT	85.73 SQM
BALCONY AREA	133.9 SQFT	12.44 SQM
TOTAL AREA	1056.69 SQFT	98.17 SQM



KEY SECTION

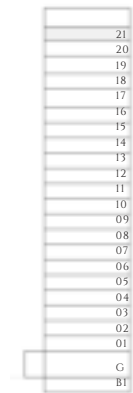

BUILDING 1B

KEY PLAN

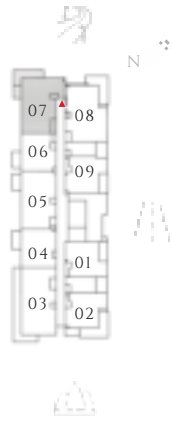

TIER 04 (LEVEL- 21)

FLOOR PLAN 1. All dimensions are in imperial and metric, and measured from finish to finish excluding construction tolerances. 2. All materials, dimensions, and drawings are approximate only. 3. Information is subject to change without notice, at developer's absolute discretion. 4. Actual area may vary from the stated area. 5. Drawings not to scale. 6. All images used are for illustrative purposes only and do not represent the actual size, features, specifications, fittings, and furnishings. 7. The developer reserves the right to make revisions / alterations, at it's absolute discretion, without any liability whatsoever.

PARK LANE

DUBAI HILLS ESTATE

INTERIORS BY VIDA

3 BEDROOM

TYPE 1 | BUILDING 1B

UNIT 1707

SUITE AREA	1369.38 SQFT	127.22 SQM
BALCONY AREA	154.68 SQFT	14.37 SQM
TOTAL AREA	1524.06 SQFT	141.59 SQM

UNITS 207, 307, 407, 507, 607, 707, 807, 907, 1007, 1107, 1207, 1307, 1407, 1507, 1607, 1807, 1907

SUITE AREA	1368.74 SQFT	127.16 SQM
BALCONY AREA	154.68 SQFT	14.37 SQM
TOTAL AREA	1523.42 SQFT	141.53 SQM



KEY SECTION

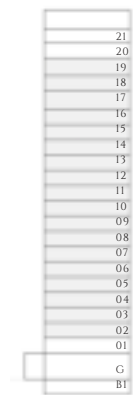

BUILDING 1B

KEY PLAN

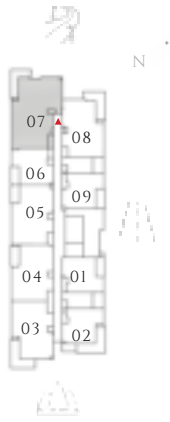

TYPICAL FLOORS (LEVEL02 - 17) TIER 01 (LEVEL- 18)

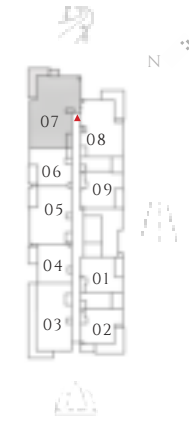
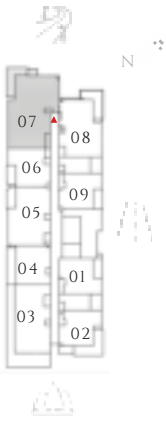

TIER 02 (LEVEL- 19)

FLOOR PLAN 1. All dimensions are in imperial and metric, and measured from finish to finish excluding construction tolerances. 2. All materials, dimensions, and drawings are approximate only. 3. Information is subject to change without notice, at developer's absolute discretion. 4. Actual area may vary from the stated area. 5. Drawings not to scale. 6. All images used are for illustrative purposes only and do not represent the actual size, features, specifications, fittings, and furnishings. 7. The developer reserves the right to make revisions / alterations, at it's absolute discretion, without any liability whatsoever.

PARK LANE

DUBAI HILLS ESTATE

INTERIORS BY VIDA

3 BEDROOM

TYPE 1.1 | BUILDING 1B

UNIT 105

SUITE AREA	1367.55 SQFT	127.05 SQM
BALCONY AREA	749.92 SQFT	69.67 SQM
TOTAL AREA	2117.48 SQFT	196.72 SQFT



KEY SECTION

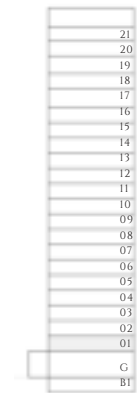

BUILDING 1B

KEY PLAN

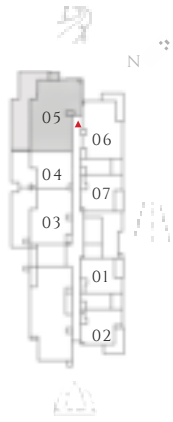

LEVEL 01

FLOOR PLAN 1. All dimensions are in imperial and metric, and measured from finish to finish excluding construction tolerances. 2. All materials, dimensions, and drawings are approximate only. 3. Information is subject to change without notice, at developer's absolute discretion. 4. Actual area may vary from the stated area. 5. Drawings not to scale. 6. All images used are for illustrative purposes only and do not represent the actual size, features, specifications, fittings, and furnishings. 7. The developer reserves the right to make revisions / alterations, at it's absolute discretion, without any liability whatsoever.

PARK LANE

DUBAI HILLS ESTATE

— INTERIORS BY VIDA —

FLOOR PLAN - BUILDING 2A

EMAAR

PARK LANE

DUBAI HILLS ESTATE

INTERIORS BY VIDA

1 BEDROOM

TYPE 1 | BUILDING 02A

UNITS 109, 209, 309, 409, 509, 609, 709, 809, 909, 1009, 1109, 1209,
1309, 1409, 1509, 1609

SUITE AREA	587.06 SQFT	54.54 SQM
BALCONY AREA	71.47 SQFT	6.64 SQM
TOTAL AREA	658.54 SQFT	61.18 SQM

UNITS 204, 304, 404, 504, 604, 704, 804, 904, 1004, 1104, 1204,
1304, 1404

SUITE AREA	583.51 SQFT	54.21 SQM
BALCONY AREA	67.49 SQFT	6.27 SQM
TOTAL AREA	651 SQFT	60.48 SQM



KEY SECTION

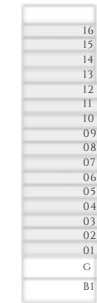

BUILDING 2A

KEY PLAN

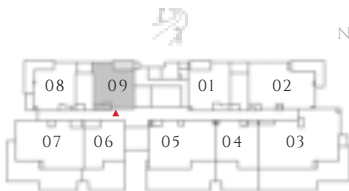

LEVEL 01

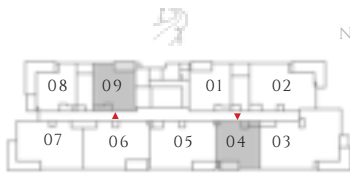

LEVEL 2-12



LEVEL 13

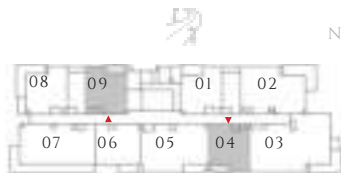

LEVEL 14

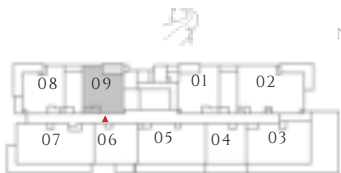

LEVEL 15

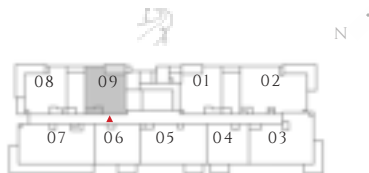

LEVEL 16

FLOOR PLAN 1. All dimensions are in imperial and metric, and measured from finish to finish excluding construction tolerances. 2. All materials, dimensions, and drawings are approximate only. 3. Information is subject to change without notice, at developer's absolute discretion. 4. Actual area may vary from the stated area. 5. Drawings not to scale. 6. All images used are for illustrative purposes only and do not represent the actual size, features, specifications, fittings, and furnishings. 7. The developer reserves the right to make revisions / alterations, at it's absolute discretion, without any liability whatsoever.

PARK LANE

DUBAI HILLS ESTATE

INTERIORS BY VIDA

1 BEDROOM

TYPE 1 MIRROR | BUILDING 02A

UNITS 101, 201, 301, 401, 501, 601, 701, 801, 901, 1001, 1101, 1201, 1301, 1401, 1501, 1601

SUITE AREA	585.13 SQFT	54.36 SQM
BALCONY AREA	71.58 SQFT	6.65 SQM
TOTAL AREA	656.71 SQFT	61.01 SQM



KEY SECTION



BUILDING 2A

KEY PLAN

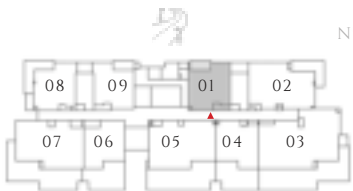

LEVEL 01



LEVEL 2-12

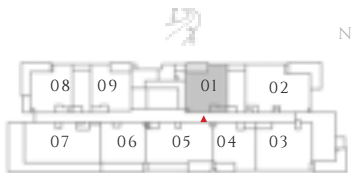

LEVEL 13

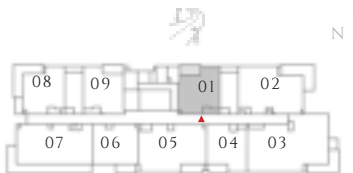

LEVEL 14

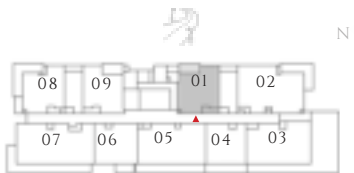

LEVEL 15

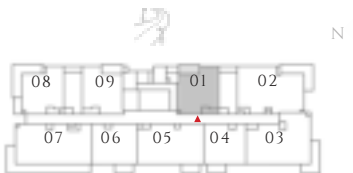

LEVEL 16

FLOOR PLAN 1. All dimensions are in imperial and metric, and measured from finish to finish excluding construction tolerances. 2. All materials, dimensions, and drawings are approximate only. 3. Information is subject to change without notice, at developer’s absolute discretion. 4. Actual area may vary from the stated area. 5. Drawings not to scale. 6. All images used are for illustrative purposes only and do not represent the actual size, features, specifications, fittings, and furnishings. 7. The developer reserves the right to make revisions / alterations, at it’s absolute discretion, without any liability whatsoever.

PARK LANE

DUBAI HILLS ESTATE

INTERIORS BY VIDA

1 BEDROOM

TYPE 1.1 | BUILDING 02A

UNITS 104

SUITE AREA	583.51 SQFT	54.21 SQM
BALCONY AREA	366.94 SQFT	34.09 SQM
TOTAL AREA	950.45 SQFT	88.3 SQM

KEYSECTION



FLOOR PLAN 1. All dimensions are in imperial and metric, and measured from finish to finish excluding construction tolerances. 2. All materials, dimensions, and drawings are approximate only. 3. Information is subject to change without notice, at developer's absolute discretion. 4. Actual area may vary from the stated area. 5. Drawings not to scale. 6. All images used are for illustrative purposes only and do not represent the actual size, features, specifications, fittings, and furnishings. 7. The developer reserves the right to make revisions / alterations, at it's absolute discretion, without any liability whatsoever.

PARK LANE

DUBAI HILLS ESTATE

INTERIORS BY VIDA

1 BEDROOM

TYPE 1A MIRROR | BUILDING 02A

UNITS 108, 1408, 1508, 1608

SUITE AREA	582.33 SQFT	54.1 SQM
BALCONY AREA	176.74 SQFT	16.42 SQM
TOTAL AREA	759.07 SQFT	70.52 SQM

UNITS 208, 308, 408, 508, 608, 708, 808, 908, 1008, 1108, 1208, 1308

SUITE AREA	582.11 SQFT	54.08 SQM
BALCONY AREA	176.64 SQFT	16.41 SQM
TOTAL AREA	758.75 SQFT	70.49 SQM



KEY SECTION



BUILDING 2A

KEY PLAN

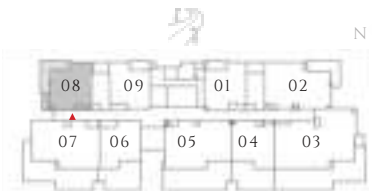

LEVEL 01

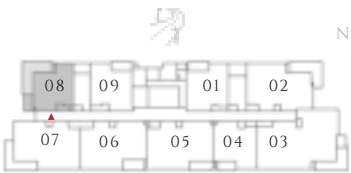

LEVEL 2-12

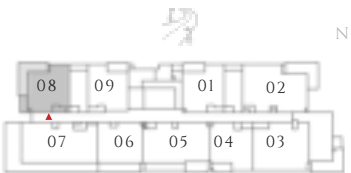

LEVEL 13

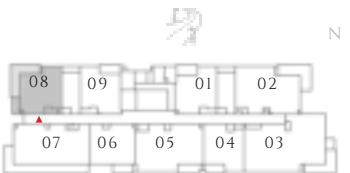

LEVEL 14

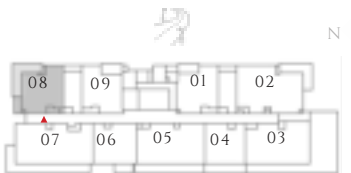

LEVEL 15

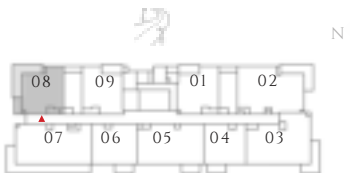

LEVEL 16

FLOOR PLAN 1. All dimensions are in imperial and metric, and measured from finish to finish excluding construction tolerances. 2. All materials, dimensions, and drawings are approximate only. 3. Information is subject to change without notice, at developer's absolute discretion. 4. Actual area may vary from the stated area. 5. Drawings not to scale. 6. All images used are for illustrative purposes only and do not represent the actual size, features, specifications, fittings, and furnishings. 7. The developer reserves the right to make revisions / alterations, at it's absolute discretion, without any liability whatsoever.

PARK LANE

DUBAI HILLS ESTATE

INTERIORS BY VIDA

1 BEDROOM

TYPE 02 MIRROR | BUILDING 02A

UNITS 1306

SUITE AREA	592.66 SQFT	55.06 SQM
BALCONY AREA	137.46 SQFT	12.77 SQM
TOTAL AREA	730.12 SQFT	67.83 SQM



KEY SECTION

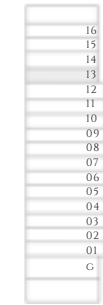

BUILDING 2A

KEY PLAN



LEVEL 13

FLOOR PLAN 1. All dimensions are in imperial and metric, and measured from finish to finish excluding construction tolerances. 2. All materials, dimensions, and drawings are approximate only. 3. Information is subject to change without notice, at developer's absolute discretion. 4. Actual area may vary from the stated area. 5. Drawings not to scale. 6. All images used are for illustrative purposes only and do not represent the actual size, features, specifications, fittings, and furnishings. 7. The developer reserves the right to make revisions / alterations, at it's absolute discretion, without any liability whatsoever.

PARK LANE

DUBAI HILLS ESTATE

INTERIORS BY VIDA

1 BEDROOM

TYPE 2.1 MIRROR | BUILDING 02A

UNITS 1406

SUITE AREA	592.55 SQFT	55.05 SQM
BALCONY AREA	65.12 SQFT	6.05 SQM
TOTAL AREA	657.67 SQFT	61.1 SQM

UNITS 1506, 1606

SUITE AREA	592.98 SQFT	55.09 SQM
BALCONY AREA	56.83 SQFT	5.28 SQM
TOTAL AREA	649.82 SQFT	60.37 SQM



KEY SECTION

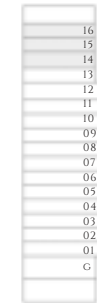

BUILDING 2A

KEY PLAN

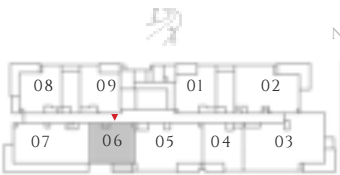

LEVEL 14

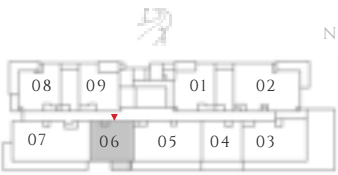

LEVEL 15

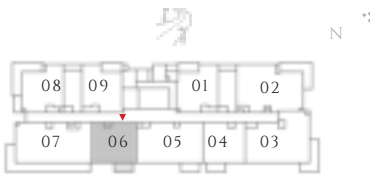

LEVEL 16

FLOOR PLAN 1. All dimensions are in imperial and metric, and measured from finish to finish excluding construction tolerances. 2. All materials, dimensions, and drawings are approximate only. 3. Information is subject to change without notice, at developer's absolute discretion. 4. Actual area may vary from the stated area. 5. Drawings not to scale. 6. All images used are for illustrative purposes only and do not represent the actual size, features, specifications, fittings, and furnishings. 7. The developer reserves the right to make revisions / alterations, at it's absolute discretion, without any liability whatsoever.

PARK LANE

DUBAI HILLS ESTATE

INTERIORS BY VIDA

1 BEDROOM

TYPE 03 MIRROR | BUILDING 02A

UNITS 1504

SUITE AREA	550.14 SQFT	51.11 SQM
BALCONY AREA	135.95 SQFT	12.63 SQM
TOTAL AREA	686.09 SQFT	63.74 SQM



KEY SECTION

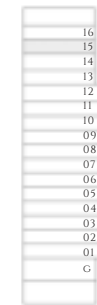

BUILDING 2A

KEY PLAN

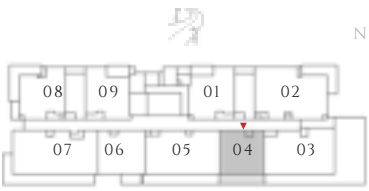

LEVEL 15

FLOOR PLAN 1. All dimensions are in imperial and metric, and measured from finish to finish excluding construction tolerances. 2. All materials, dimensions, and drawings are approximate only. 3. Information is subject to change without notice, at developer's absolute discretion. 4. Actual area may vary from the stated area. 5. Drawings not to scale. 6. All images used are for illustrative purposes only and do not represent the actual size, features, specifications, fittings, and furnishings. 7. The developer reserves the right to make revisions / alterations, at it's absolute discretion, without any liability whatsoever.

PARK LANE

DUBAI HILLS ESTATE

INTERIORS BY VIDA

1 BEDROOM

TYPE 3.1 MIRROR | BUILDING 02A

UNITS 1604

SUITE AREA	550.25 SQFT	51.12 SQM
BALCONY AREA	56.73 SQFT	5.27 SQM
TOTAL AREA	606.98 SQFT	56.39 SQM



KEY SECTION

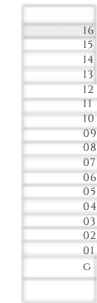

BUILDING 2A

KEY PLAN

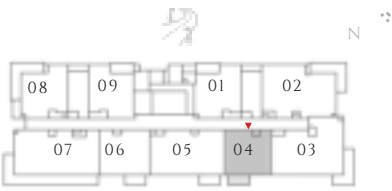

LEVEL 16

FLOOR PLAN 1. All dimensions are in imperial and metric, and measured from finish to finish excluding construction tolerances. 2. All materials, dimensions, and drawings are approximate only. 3. Information is subject to change without notice, at developer’s absolute discretion. 4. Actual area may vary from the stated area. 5. Drawings not to scale. 6. All images used are for illustrative purposes only and do not represent the actual size, features, specifications, fittings, and furnishings. 7. The developer reserves the right to make revisions / alterations, at it’s absolute discretion, without any liability whatsoever.

PARK LANE

DUBAI HILLS ESTATE

INTERIORS BY VIDA

1 BEDROOM

TYPE 04 MIRROR | BUILDING 02A

UNITS 106

SUITE AREA	559.08 SQFT	51.94 SQM
BALCONY AREA	356.61 SQFT	33.13 SQM
TOTAL AREA	915.69 SQFT	85.07 SQM



KEY SECTION

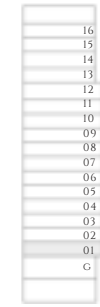

BUILDING 2A

KEY PLAN

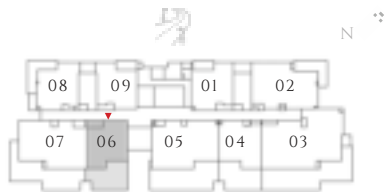

LEVEL 01

FLOOR PLAN 1. All dimensions are in imperial and metric, and measured from finish to finish excluding construction tolerances. 2. All materials, dimensions, and drawings are approximate only. 3. Information is subject to change without notice, at developer’s absolute discretion. 4. Actual area may vary from the stated area. 5. Drawings not to scale. 6. All images used are for illustrative purposes only and do not represent the actual size, features, specifications, fittings, and furnishings. 7. The developer reserves the right to make revisions / alterations, at it’s absolute discretion, without any liability whatsoever.

PARK LANE

DUBAI HILLS ESTATE

INTERIORS BY VIDA

2 BEDROOM

TYPE 1 MIRROR | BUILDING 02A

UNITS 102, 202, 302, 402, 502, 602, 702, 802, 902, 1002, 1102, 1202, 1302, 1402

SUITE AREA	960.79 SQFT	89.26 SQM
BALCONY AREA	160.27 SQFT	14.89 SQM
TOTAL AREA	1121.06 SQFT	104.15 SQM

UNITS 207, 307, 407, 507, 607, 707, 807, 907, 1007, 1107, 1207

SUITE AREA	958.42 SQFT	89.04 SQM
BALCONY AREA	171.58 SQFT	15.94 SQM
TOTAL AREA	1130 SQFT	104.98 SQM



KEY SECTION

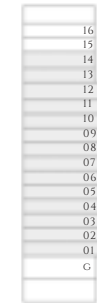

BUILDING 2A

KEY PLAN

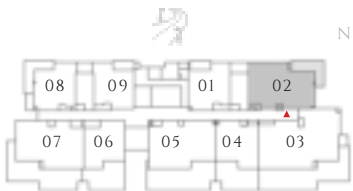

LEVEL 01



LEVEL 2-12

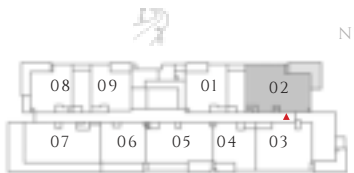

LEVEL 13



LEVEL 14

FLOOR PLAN 1. All dimensions are in imperial and metric, and measured from finish to finish excluding construction tolerances. 2. All materials, dimensions, and drawings are approximate only. 3. Information is subject to change without notice, at developer’s absolute discretion. 4. Actual area may vary from the stated area. 5. Drawings not to scale. 6. All images used are for illustrative purposes only and do not represent the actual size, features, specifications, fittings, and furnishings. 7. The developer reserves the right to make revisions / alterations, at it’s absolute discretion, without any liability whatsoever.

PARK LANE

DUBAI HILLS ESTATE

INTERIORS BY VIDA

2 BEDROOM

TYPE 1 MIRROR | BUILDING 02A

UNITS 1502, 1602

SUITE AREA	961.76 SQFT	89.35 SQM
BALCONY AREA	161.35 SQFT	14.99 SQM
TOTAL AREA	1123.11 SQFT	104.34 SQM



KEY SECTION

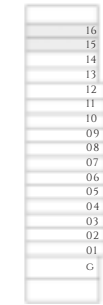

BUILDING 2A

KEY PLAN

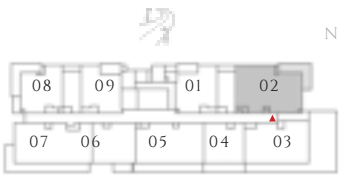

LEVEL 15

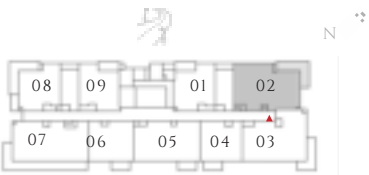

LEVEL 16

FLOOR PLAN 1. All dimensions are in imperial and metric, and measured from finish to finish excluding construction tolerances. 2. All materials, dimensions, and drawings are approximate only. 3. Information is subject to change without notice, at developer's absolute discretion. 4. Actual area may vary from the stated area. 5. Drawings not to scale. 6. All images used are for illustrative purposes only and do not represent the actual size, features, specifications, fittings, and furnishings. 7. The developer reserves the right to make revisions / alterations, at it's absolute discretion, without any liability whatsoever.

PARK LANE

DUBAI HILLS ESTATE

INTERIORS BY VIDA

2 BEDROOM

2BHK TYPE 1.1 MIRROR | BUILDING 02A

UNIT 107

SUITE AREA	957.67 SQFT	88.97 SQM
BALCONY AREA	709.23 SQFT	65.89 SQM
TOTAL AREA	1666.9 SQFT	154.86 SQM

KEY SECTION

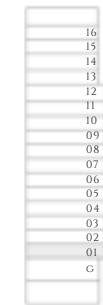

BUILDING 2A

KEY PLAN

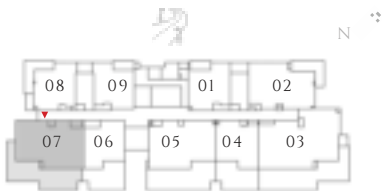

LEVEL 01



FLOOR PLAN 1. All dimensions are in imperial and metric, and measured from finish to finish excluding construction tolerances. 2. All materials, dimensions, and drawings are approximate only. 3. Information is subject to change without notice, at developer’s absolute discretion. 4. Actual area may vary from the stated area. 5. Drawings not to scale. 6. All images used are for illustrative purposes only and do not represent the actual size, features, specifications, fittings, and furnishings. 7. The developer reserves the right to make revisions / alterations, at it’s absolute discretion, without any liability whatsoever.

PARK LANE

DUBAI HILLS ESTATE

INTERIORS BY VIDA

2 BEDROOM

TYPE 1 A MIRROR | BUILDING 02A

UNITS 205, 305, 405, 505, 605, 705, 805, 905, 1005, 1105, 1205, 1405

SUITE AREA	963.59 SQFT	89.52 SQM
BALCONY AREA	76.85 SQFT	7.14 SQM
TOTAL AREA	1040.44 SQFT	96.66 SQM

UNITS 206,306, 406, 506, 606, 706, 806, 906, 1006, 1106, 1206

SUITE AREA	963.26 SQFT	89.49 SQM
BALCONY AREA	73.41 SQFT	6.82 SQM
TOTAL AREA	1036.67 SQFT	96.31 SQM



KEY SECTION

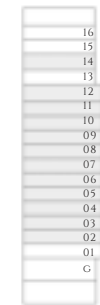

BUILDING 2A

KEY PLAN

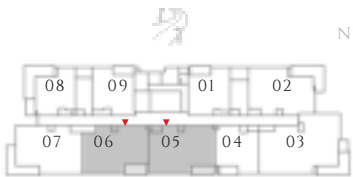

LEVEL 2-12

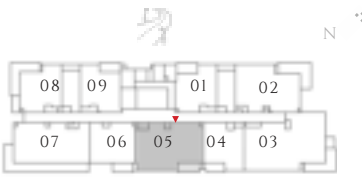

LEVEL 14

FLOOR PLAN 1. All dimensions are in imperial and metric, and measured from finish to finish excluding construction tolerances. 2. All materials, dimensions, and drawings are approximate only. 3. Information is subject to change without notice, at developer’s absolute discretion. 4. Actual area may vary from the stated area. 5. Drawings not to scale. 6. All images used are for illustrative purposes only and do not represent the actual size, features, specifications, fittings, and furnishings. 7. The developer reserves the right to make revisions / alterations, at it’s absolute discretion, without any liability whatsoever.

PARK LANE

DUBAI HILLS ESTATE

INTERIORS BY VIDA

2 BEDROOM

TYPE 1 A MIRROR | BUILDING 02A

UNITS 1305

SUITE AREA	963.37 SQFT	89.5 SQM
BALCONY AREA	78.15 SQFT	7.26 SQM
TOTAL AREA	1041.52 SQFT	96.76 SQM



KEY SECTION

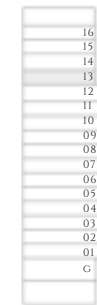

BUILDING 2A

KEY PLAN



LEVEL 13

FLOOR PLAN 1. All dimensions are in imperial and metric, and measured from finish to finish excluding construction tolerances. 2. All materials, dimensions, and drawings are approximate only. 3. Information is subject to change without notice, at developer's absolute discretion. 4. Actual area may vary from the stated area. 5. Drawings not to scale. 6. All images used are for illustrative purposes only and do not represent the actual size, features, specifications, fittings, and furnishings. 7. The developer reserves the right to make revisions / alterations, at it's absolute discretion, without any liability whatsoever.

PARK LANE

DUBAI HILLS ESTATE

INTERIORS BY VIDA

2 BEDROOM

TYPE 1 A.1 MIRROR | BUILDING 02A

UNITS 105

SUITE AREA	963.26 SQFT	89.49 SQM
BALCONY AREA	583.3 SQFT	54.19 SQM
TOTAL AREA	1546.56 SQFT	143.68 SQM

KEY SECTION

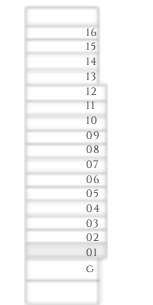

BUILDING 2A

KEY PLAN

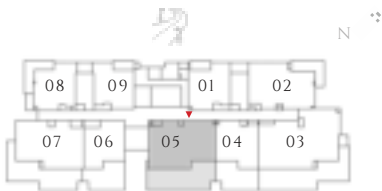

LEVEL 01



FLOOR PLAN 1. All dimensions are in imperial and metric, and measured from finish to finish excluding construction tolerances. 2. All materials, dimensions, and drawings are approximate only. 3. Information is subject to change without notice, at developer's absolute discretion. 4. Actual area may vary from the stated area. 5. Drawings not to scale. 6. All images used are for illustrative purposes only and do not represent the actual size, features, specifications, fittings, and furnishings. 7. The developer reserves the right to make revisions / alterations, at it's absolute discretion, without any liability whatsoever.

PARK LANE

DUBAI HILLS ESTATE

INTERIORS BY VIDA

2 BEDROOM

TYPE 2 MIRROR | BUILDING 02A

UNIT 1307

SUITE AREA	977.26 SQFT	90.79 SQM
BALCONY AREA	527.65 SQFT	49.02 SQM
TOTAL AREA	1504.9 SQFT	139.81 SQM



KEY SECTION

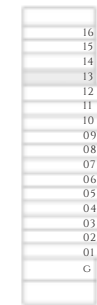

BUILDING 2A

KEY PLAN

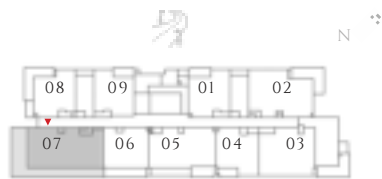

LEVEL 13

FLOOR PLAN 1. All dimensions are in imperial and metric, and measured from finish to finish excluding construction tolerances. 2. All materials, dimensions, and drawings are approximate only. 3. Information is subject to change without notice, at developer's absolute discretion. 4. Actual area may vary from the stated area. 5. Drawings not to scale. 6. All images used are for illustrative purposes only and do not represent the actual size, features, specifications, fittings, and furnishings. 7. The developer reserves the right to make revisions / alterations, at it's absolute discretion, without any liability whatsoever.

PARK LANE

DUBAI HILLS ESTATE

INTERIORS BY VIDA

2 BEDROOM

TYPE 2.1 MIRROR | BUILDING 02A

UNITS 1407, 1507, 1607

SUITE AREA	977.58 SQFT	90.82 SQM
BALCONY AREA	330.02 SQFT	30.66 SQM
TOTAL AREA	1307.6 SQFT	121.48 SQM



KEY SECTION

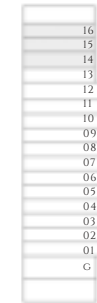

BUILDING 2A

KEY PLAN



LEVEL 14

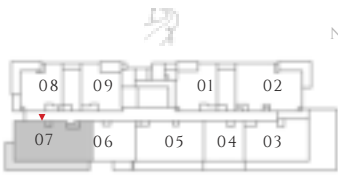

LEVEL 15

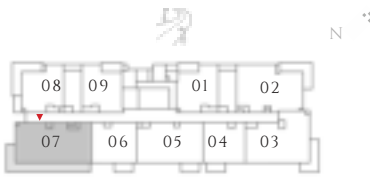

LEVEL 16

FLOOR PLAN 1. All dimensions are in imperial and metric, and measured from finish to finish excluding construction tolerances. 2. All materials, dimensions, and drawings are approximate only. 3. Information is subject to change without notice, at developer’s absolute discretion. 4. Actual area may vary from the stated area. 5. Drawings not to scale. 6. All images used are for illustrative purposes only and do not represent the actual size, features, specifications, fittings, and furnishings. 7. The developer reserves the right to make revisions / alterations, at it’s absolute discretion, without any liability whatsoever.

PARK LANE

DUBAI HILLS ESTATE

INTERIORS BY VIDA

2 BEDROOM

TYPE 3 MIRROR | BUILDING 02A

UNITS 1505

SUITE AREA	866.06 SQFT	80.46 SQM
BALCONY AREA	223.46 SQFT	20.76 SQM
TOTAL AREA	1089.52 SQFT	101.22 SQM



KEY SECTION

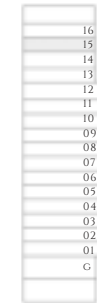

BUILDING 2A

KEY PLAN

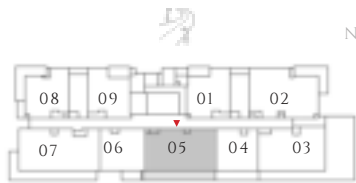

LEVEL 15

FLOOR PLAN 1. All dimensions are in imperial and metric, and measured from finish to finish excluding construction tolerances. 2. All materials, dimensions, and drawings are approximate only. 3. Information is subject to change without notice, at developer's absolute discretion. 4. Actual area may vary from the stated area. 5. Drawings not to scale. 6. All images used are for illustrative purposes only and do not represent the actual size, features, specifications, fittings, and furnishings. 7. The developer reserves the right to make revisions / alterations, at it's absolute discretion, without any liability whatsoever.

PARK LANE

DUBAI HILLS ESTATE

INTERIORS BY VIDA

2 BEDROOM

TYPE 3.1 MIRROR | BUILDING 02A

UNIT 1605

SUITE AREA	866.17 SQFT	80.47 SQM
BALCONY AREA	56.83 SQFT	5.28 SQM
TOTAL AREA	923.01 SQFT	85.75 SQM



KEY SECTION

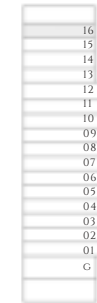

BUILDING 2A

KEY PLAN

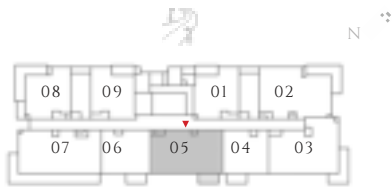

LEVEL 16

FLOOR PLAN 1. All dimensions are in imperial and metric, and measured from finish to finish excluding construction tolerances. 2. All materials, dimensions, and drawings are approximate only. 3. Information is subject to change without notice, at developer's absolute discretion. 4. Actual area may vary from the stated area. 5. Drawings not to scale. 6. All images used are for illustrative purposes only and do not represent the actual size, features, specifications, fittings, and furnishings. 7. The developer reserves the right to make revisions / alterations, at it's absolute discretion, without any liability whatsoever.

PARK LANE

DUBAI HILLS ESTATE

INTERIORS BY VIDA

2 BEDROOM

TYPE 4 MIRROR | BUILDING 02A

UNITS 1503

SUITE AREA	923.33 SQFT	85.78 SQM
BALCONY AREA	794.27 SQFT	73.79 SQM
TOTAL AREA	1717.6 SQFT	159.57 SQM



KEY SECTION

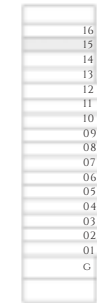

BUILDING 2A

KEY PLAN

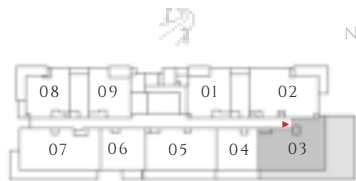

LEVEL 15

FLOOR PLAN 1. All dimensions are in imperial and metric, and measured from finish to finish excluding construction tolerances. 2. All materials, dimensions, and drawings are approximate only. 3. Information is subject to change without notice, at developer's absolute discretion. 4. Actual area may vary from the stated area. 5. Drawings not to scale. 6. All images used are for illustrative purposes only and do not represent the actual size, features, specifications, fittings, and furnishings. 7. The developer reserves the right to make revisions / alterations, at it's absolute discretion, without any liability whatsoever.

PARK LANE

DUBAI HILLS ESTATE

INTERIORS BY VIDA

2 BEDROOM

TYPE 4.1 MIRROR | BUILDING 02A

UNIT 1603

SUITE AREA	922.36 SQFT	85.69 SQM
BALCONY AREA	134.33 SQFT	12.48 SQM
TOTAL AREA	1056.69 SQFT	98.17 SQM



KEY SECTION

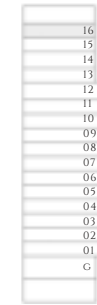

BUILDING 2A

KEY PLAN

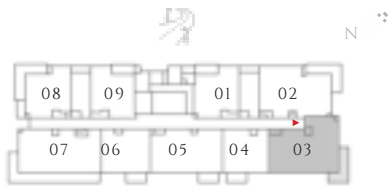

LEVEL 16

FLOOR PLAN 1. All dimensions are in imperial and metric, and measured from finish to finish excluding construction tolerances. 2. All materials, dimensions, and drawings are approximate only. 3. Information is subject to change without notice, at developer's absolute discretion. 4. Actual area may vary from the stated area. 5. Drawings not to scale. 6. All images used are for illustrative purposes only and do not represent the actual size, features, specifications, fittings, and furnishings. 7. The developer reserves the right to make revisions / alterations, at it's absolute discretion, without any liability whatsoever.

PARK LANE

DUBAI HILLS ESTATE

INTERIORS BY VIDA

3 BEDROOM

TYPE 1 MIRROR | BUILDING 02A

UNIT 203, 303, 403, 503, 603, 703, 803, 903, 1003, 1103, 1403

SUITE AREA	1368.74 SQFT	127.16 SQM
BALCONY AREA	154.79 SQFT	14.38 SQM
TOTAL AREA	1523.52 SQFT	141.54 SQM

UNITS 1203, 1303

SUITE AREA	1368.85 SQFT	127.17 SQM
BALCONY AREA	155.22 SQFT	14.42 SQM
TOTAL AREA	1524.06 SQFT	141.59 SQM



KEY SECTION



BUILDING 2A

KEY PLAN

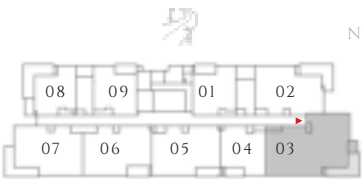

LEVEL 2-12



LEVEL 13

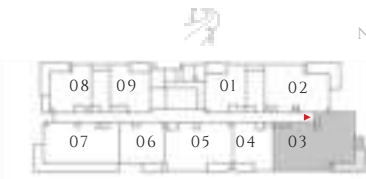

LEVEL 14

FLOOR PLAN 1. All dimensions are in imperial and metric, and measured from finish to finish excluding construction tolerances. 2. All materials, dimensions, and drawings are approximate only. 3. Information is subject to change without notice, at developer's absolute discretion. 4. Actual area may vary from the stated area. 5. Drawings not to scale. 6. All images used are for illustrative purposes only and do not represent the actual size, features, specifications, fittings, and furnishings. 7. The developer reserves the right to make revisions / alterations, at it's absolute discretion, without any liability whatsoever.

PARK LANE

DUBAI HILLS ESTATE

INTERIORS BY VIDA

3 BEDROOM

TYPE 1.1 MIRROR | BUILDING 02A

UNIT 103

SUITE AREA	1368.74 SQFT	127.16 SQM
BALCONY AREA	712.25 SQFT	66.17 SQM
TOTAL AREA	2080.99 SQFT	193.33 SQM

KEY SECTION

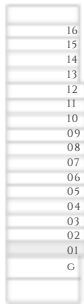

BUILDING 2A

KEY PLAN

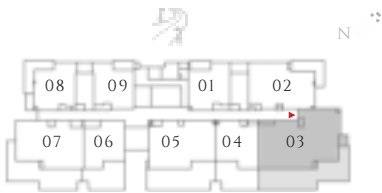

LEVEL 01



FLOOR PLAN 1. All dimensions are in imperial and metric, and measured from finish to finish excluding construction tolerances. 2. All materials, dimensions, and drawings are approximate only. 3. Information is subject to change without notice, at developer's absolute discretion. 4. Actual area may vary from the stated area. 5. Drawings not to scale. 6. All images used are for illustrative purposes only and do not represent the actual size, features, specifications, fittings, and furnishings. 7. The developer reserves the right to make revisions / alterations, at it's absolute discretion, without any liability whatsoever.

PARK LANE

DUBAI HILLS ESTATE

—— INTERIORS BY VIDA ——

BUILDING 2A

PARK LANE

DUBAI HILLS ESTATE

— INTERIORS BY VIDA —

FLOOR PLAN - BUILDING 2B

EMAAR

PARK LANE

DUBAI HILLS ESTATE

INTERIORS BY VIDA

1 BEDROOM

TYPE 1 | BUILDING 02B

UNITS 109, 209, 309, 409, 509, 609, 709, 809, 909, 1009, 1109, 1209,
1309, 1409, 1509, 1609

SUITE AREA	587.06 SQFT	54.54 SQM
BALCONY AREA	71.47 SQFT	6.64 SQM
TOTAL AREA	658.54 SQFT	61.18 SQM

UNITS 204, 304, 404, 504, 604, 704, 804, 904, 1004, 1104, 1204,
1304, 1404

SUITE AREA	583.51 SQFT	54.21 SQM
BALCONY AREA	68.24 SQFT	6.34 SQM
TOTAL AREA	651.75 SQFT	60.55 SQM



KEY SECTION

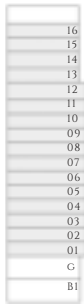

BUILDING 2B

KEY PLAN



LEVEL 01



LEVEL 2-12

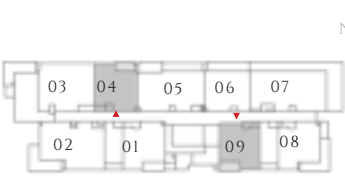

LEVEL 13

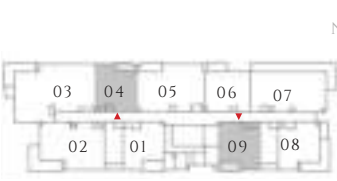

LEVEL 14

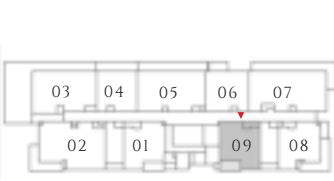

LEVEL 15

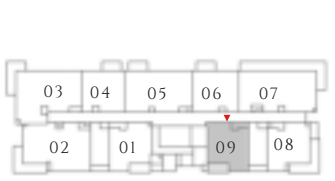

LEVEL 16

FLOOR PLAN 1. All dimensions are in imperial and metric, and measured from finish to finish excluding construction tolerances. 2. All materials, dimensions, and drawings are approximate only. 3. Information is subject to change without notice, at developer’s absolute discretion. 4. Actual area may vary from the stated area. 5. Drawings not to scale. 6. All images used are for illustrative purposes only and do not represent the actual size, features, specifications, fittings, and furnishings. 7. The developer reserves the right to make revisions / alterations, at it’s absolute discretion, without any liability whatsoever.

PARK LANE

DUBAI HILLS ESTATE

INTERIORS BY VIDA

1 BEDROOM

TYPE 1 MIRROR | BUILDING 02B

UNITS 101, 201, 301, 401, 501, 601, 701, 801, 901, 1001, 1101, 1201,
1301, 1401, 1501, 1601

SUITE AREA	585.02 SQFT	54.35 SQM
BALCONY AREA	71.8 SQFT	6.67 SQM
TOTAL AREA	656.81 SQFT	61.02 SQM



KEY SECTION

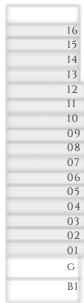

BUILDING 2B

KEY PLAN

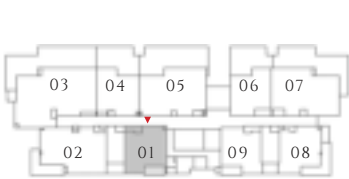

LEVEL 01

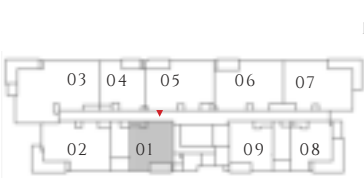

LEVEL 2-12

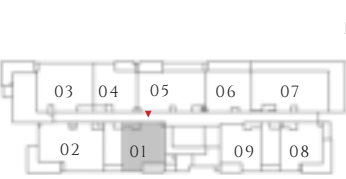

LEVEL 13

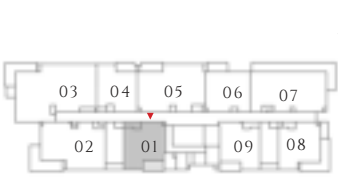

LEVEL 14

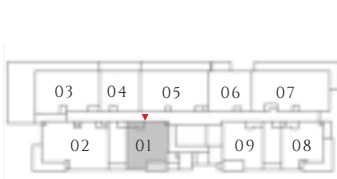

LEVEL 15

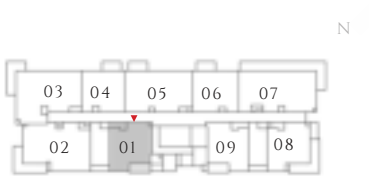

LEVEL 16

FLOOR PLAN 1. All dimensions are in imperial and metric, and measured from finish to finish excluding construction tolerances. 2. All materials, dimensions, and drawings are approximate only. 3. Information is subject to change without notice, at developer's absolute discretion. 4. Actual area may vary from the stated area. 5. Drawings not to scale. 6. All images used are for illustrative purposes only and do not represent the actual size, features, specifications, fittings, and furnishings. 7. The developer reserves the right to make revisions / alterations, at it's absolute discretion, without any liability whatsoever.

PARK LANE

DUBAI HILLS ESTATE

INTERIORS BY VIDA

1 BEDROOM

TYPE 1.1 | BUILDING 02B

UNITS 104

SUITE AREA	583.51 SQFT	54.21 SQM
BALCONY AREA	365.97 SQFT	34 SQM
TOTAL AREA	949.48 SQFT	88.21 SQM

KEY SECTION

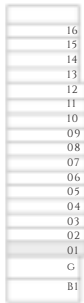

BUILDING 2B

KEY PLAN

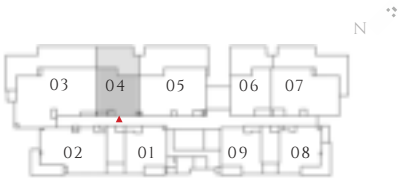

LEVEL 01



FLOOR PLAN 1. All dimensions are in imperial and metric, and measured from finish to finish excluding construction tolerances. 2. All materials, dimensions, and drawings are approximate only. 3. Information is subject to change without notice, at developer’s absolute discretion. 4. Actual area may vary from the stated area. 5. Drawings not to scale. 6. All images used are for illustrative purposes only and do not represent the actual size, features, specifications, fittings, and furnishings. 7. The developer reserves the right to make revisions / alterations, at it’s absolute discretion, without any liability whatsoever.

PARK LANE

DUBAI HILLS ESTATE

INTERIORS BY VIDA

1 BEDROOM

TYPE 1A MIRROR | BUILDING 02B

UNITS 1408, 1508, 1608

SUITE AREA	582.33 SQFT	54.1 SQM
BALCONY AREA	176.85 SQFT	16.43 SQM
TOTAL AREA	759.18 SQFT	70.53 SQM

UNITS 108, 208, 308, 408, 508, 608, 708, 808, 908, 1008, 1108, 1208, 1308

SUITE AREA	581.9 SQFT	54.06 SQM
BALCONY AREA	176.64 SQFT	16.41 SQM
TOTAL AREA	758.53 SQFT	70.47 SQM



KEY SECTION

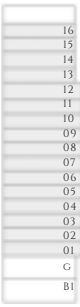

BUILDING 2B

KEY PLAN

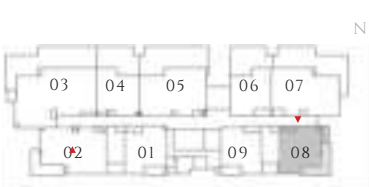

LEVEL 01

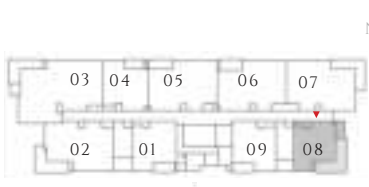

LEVEL 2-12

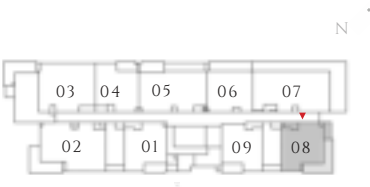

LEVEL 13

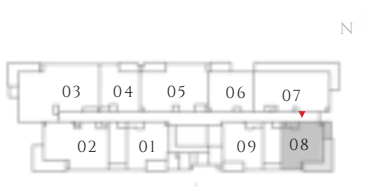

LEVEL 14

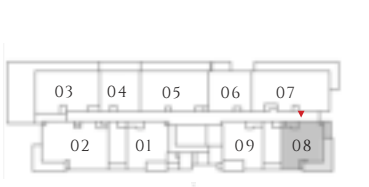

LEVEL 15

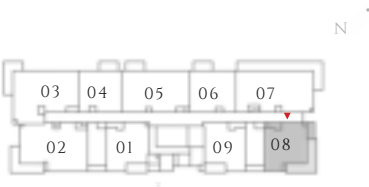

LEVEL 16

FLOOR PLAN 1. All dimensions are in imperial and metric, and measured from finish to finish excluding construction tolerances. 2. All materials, dimensions, and drawings are approximate only. 3. Information is subject to change without notice, at developer’s absolute discretion. 4. Actual area may vary from the stated area. 5. Drawings not to scale. 6. All images used are for illustrative purposes only and do not represent the actual size, features, specifications, fittings, and furnishings. 7. The developer reserves the right to make revisions / alterations, at it’s absolute discretion, without any liability whatsoever.

PARK LANE

DUBAI HILLS ESTATE

INTERIORS BY VIDA

1 BEDROOM

TYPE 02 MIRROR | BUILDING 02B

UNITS 1306

SUITE AREA	592.66 SQFT	55.06 SQM
BALCONY AREA	137.46 SQFT	12.77 SQM
TOTAL AREA	730.12 SQFT	67.83 SQM



KEYSECTION

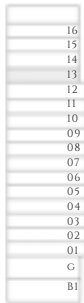

BUILDING 2B

KEY PLAN

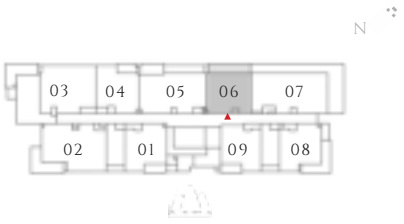

LEVEL 13

FLOOR PLAN 1. All dimensions are in imperial and metric, and measured from finish to finish excluding construction tolerances. 2. All materials, dimensions, and drawings are approximate only. 3. Information is subject to change without notice, at developer's absolute discretion. 4. Actual area may vary from the stated area. 5. Drawings not to scale. 6. All images used are for illustrative purposes only and do not represent the actual size, features, specifications, fittings, and furnishings. 7. The developer reserves the right to make revisions / alterations, at it's absolute discretion, without any liability whatsoever.

PARK LANE

DUBAI HILLS ESTATE

INTERIORS BY VIDA

1 BEDROOM

TYPE 2.1 MIRROR | BUILDING 02B

UNITS 1406

SUITE AREA	592.66 SQFT	55.06 SQM
BALCONY AREA	65.12 SQFT	6.05 SQM
TOTAL AREA	657.78 SQFT	61.11 SQM

UNITS 1506, 1606

SUITE AREA	592.98 SQFT	55.09 SQM
BALCONY AREA	56.83 SQFT	5.28 SQM
TOTAL AREA	649.82 SQFT	60.37 SQM



KEY SECTION

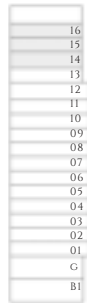

BUILDING 2B

KEY PLAN

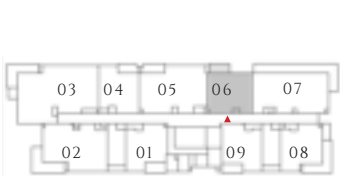

LEVEL 14

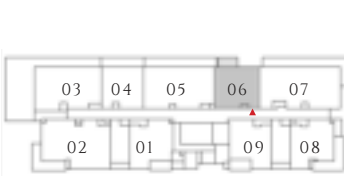

LEVEL 15

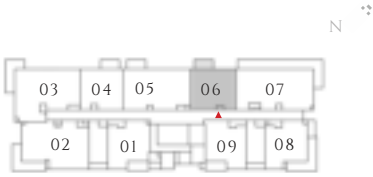

LEVEL 16

FLOOR PLAN 1. All dimensions are in imperial and metric, and measured from finish to finish excluding construction tolerances. 2. All materials, dimensions, and drawings are approximate only. 3. Information is subject to change without notice, at developer's absolute discretion. 4. Actual area may vary from the stated area. 5. Drawings not to scale. 6. All images used are for illustrative purposes only and do not represent the actual size, features, specifications, fittings, and furnishings. 7. The developer reserves the right to make revisions / alterations, at it's absolute discretion, without any liability whatsoever.

PARK LANE

DUBAI HILLS ESTATE

INTERIORS BY VIDA

1 BEDROOM

TYPE 03 MIRROR | BUILDING 02B

UNITS 1504

SUITE AREA	550.14 SQFT	51.11 SQM
BALCONY AREA	135.95 SQFT	12.63 SQM
TOTAL AREA	686.09 SQFT	63.74 SQM



KEY SECTION

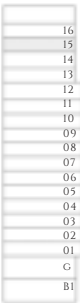

BUILDING 2B

KEY PLAN

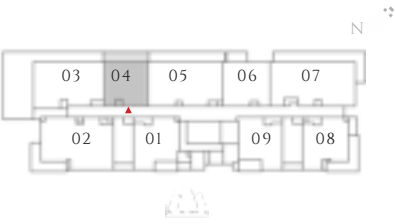

LEVEL 15

FLOOR PLAN 1. All dimensions are in imperial and metric, and measured from finish to finish excluding construction tolerances. 2. All materials, dimensions, and drawings are approximate only. 3. Information is subject to change without notice, at developer's absolute discretion. 4. Actual area may vary from the stated area. 5. Drawings not to scale. 6. All images used are for illustrative purposes only and do not represent the actual size, features, specifications, fittings, and furnishings. 7. The developer reserves the right to make revisions / alterations, at it's absolute discretion, without any liability whatsoever.

PARK LANE

DUBAI HILLS ESTATE

INTERIORS BY VIDA

1 BEDROOM

TYPE 3.1 MIRROR | BUILDING 02B

UNITS 1604

SUITE AREA	550.36 SQFT	51.13 SQM
BALCONY AREA	56.73 SQFT	5.27 SQM
TOTAL AREA	607.08 SQFT	56.4 SQM



KEY SECTION

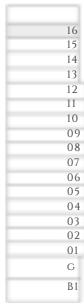

BUILDING 2B

KEY PLAN

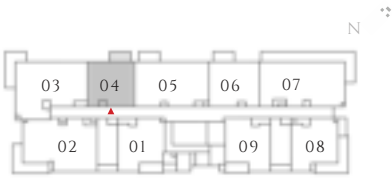

LEVEL 16

FLOOR PLAN 1. All dimensions are in imperial and metric, and measured from finish to finish excluding construction tolerances. 2. All materials, dimensions, and drawings are approximate only. 3. Information is subject to change without notice, at developer's absolute discretion. 4. Actual area may vary from the stated area. 5. Drawings not to scale. 6. All images used are for illustrative purposes only and do not represent the actual size, features, specifications, fittings, and furnishings. 7. The developer reserves the right to make revisions / alterations, at it's absolute discretion, without any liability whatsoever.

PARK LANE

DUBAI HILLS ESTATE

INTERIORS BY VIDA

1 BEDROOM

TYPE 04 MIRROR | BUILDING 02B

UNITS 106

SUITE AREA	559.08 SQFT	51.94 SQM
BALCONY AREA	351.98 SQFT	32.7 SQM
TOTAL AREA	911.06 SQFT	84.64 SQM



KEY SECTION

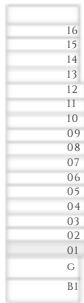

BUILDING 2B

KEY PLAN

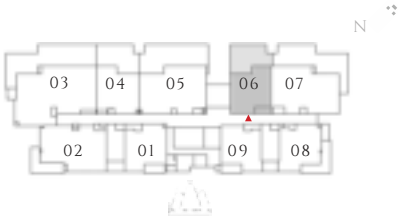

LEVEL 01

FLOOR PLAN 1. All dimensions are in imperial and metric, and measured from finish to finish excluding construction tolerances. 2. All materials, dimensions, and drawings are approximate only. 3. Information is subject to change without notice, at developer's absolute discretion. 4. Actual area may vary from the stated area. 5. Drawings not to scale. 6. All images used are for illustrative purposes only and do not represent the actual size, features, specifications, fittings, and furnishings. 7. The developer reserves the right to make revisions / alterations, at it's absolute discretion, without any liability whatsoever.

PARK LANE

DUBAI HILLS ESTATE

INTERIORS BY VIDA

2 BEDROOM

TYPE 1 MIRROR | BUILDING 02B

UNITS 102, 202, 302, 402, 502, 602, 702, 802, 902, 1002, 1102, 1202, 1302, 1402

SUITE AREA	961.11 SQFT	89.29 SQM
BALCONY AREA	160.17 SQFT	14.88 SQM
TOTAL AREA	1121.28 SQFT	104.17 SQM

UNITS 207, 307, 407, 507, 607, 707, 807, 907, 1007, 1107

SUITE AREA	958.42 SQFT	89.04 SQM
BALCONY AREA	171.58 SQFT	15.94 SQM
TOTAL AREA	1130 SQFT	104.98 SQM



KEY SECTION

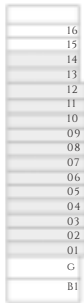

BUILDING 2B

KEY PLAN

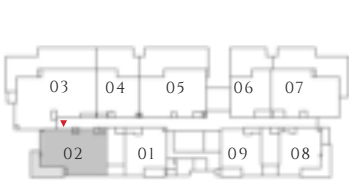

LEVEL 01

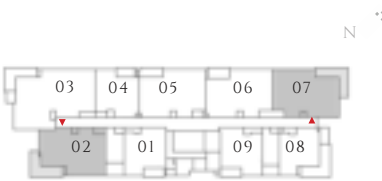

LEVEL 2-12

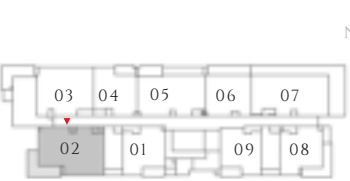

LEVEL 13

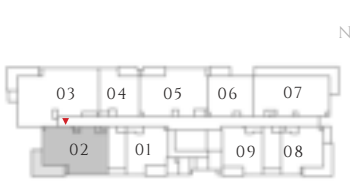

LEVEL 14

FLOOR PLAN 1. All dimensions are in imperial and metric, and measured from finish to finish excluding construction tolerances. 2. All materials, dimensions, and drawings are approximate only. 3. Information is subject to change without notice, at developer’s absolute discretion. 4. Actual area may vary from the stated area. 5. Drawings not to scale. 6. All images used are for illustrative purposes only and do not represent the actual size, features, specifications, fittings, and furnishings. 7. The developer reserves the right to make revisions / alterations, at it’s absolute discretion, without any liability whatsoever.

PARK LANE

DUBAI HILLS ESTATE

INTERIORS BY VIDA

2 BEDROOM

TYPE 1 MIRROR | BUILDING 02B

UNITS 1502

SUITE AREA	961.76 SQFT	89.35 SQM
BALCONY AREA	161.35 SQFT	14.99 SQM
TOTAL AREA	1123.11 SQFT	104.34 SQM

UNITS 1602

SUITE AREA	961.76 SQFT	89.35 SQM
BALCONY AREA	160.38 SQFT	14.9 SQM
TOTAL AREA	1122.14 SQFT	104.25 SQM



KEY SECTION

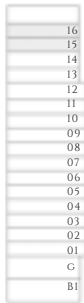

BUILDING 2B

KEY PLAN

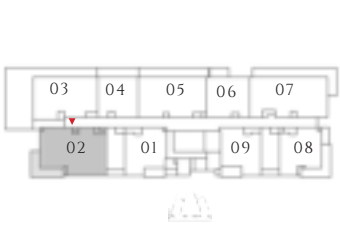

LEVEL 15



LEVEL 16

FLOOR PLAN 1. All dimensions are in imperial and metric, and measured from finish to finish excluding construction tolerances. 2. All materials, dimensions, and drawings are approximate only. 3. Information is subject to change without notice, at developer’s absolute discretion. 4. Actual area may vary from the stated area. 5. Drawings not to scale. 6. All images used are for illustrative purposes only and do not represent the actual size, features, specifications, fittings, and furnishings. 7. The developer reserves the right to make revisions / alterations, at it’s absolute discretion, without any liability whatsoever.

PARK LANE

DUBAI HILLS ESTATE

INTERIORS BY VIDA

2 BEDROOM

TYPE 1 MIRROR | BUILDING 02B

UNITS 1207

SUITE AREA	958.31 SQFT	89.03 SQM
BALCONY AREA	171.58 SQFT	15.94 SQM
TOTAL AREA	1129.89 SQFT	104.97 SQM



KEY SECTION

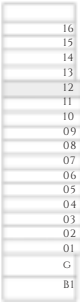

BUILDING 2B

KEY PLAN



LEVEL 12

FLOOR PLAN 1. All dimensions are in imperial and metric, and measured from finish to finish excluding construction tolerances. 2. All materials, dimensions, and drawings are approximate only. 3. Information is subject to change without notice, at developer's absolute discretion. 4. Actual area may vary from the stated area. 5. Drawings not to scale. 6. All images used are for illustrative purposes only and do not represent the actual size, features, specifications, fittings, and furnishings. 7. The developer reserves the right to make revisions / alterations, at it's absolute discretion, without any liability whatsoever.

PARK LANE

DUBAI HILLS ESTATE

INTERIORS BY VIDA

2 BEDROOM

2BHK TYPE 1.1 MIRROR | BUILDING 02B

UNIT 107

SUITE AREA	957.77 SQFT	88.98 SQM
BALCONY AREA	560.05 SQFT	52.03 SQM
TOTAL AREA	1517.82 SQFT	141.01 SQM



KEY SECTION

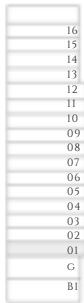

BUILDING 2B

KEY PLAN

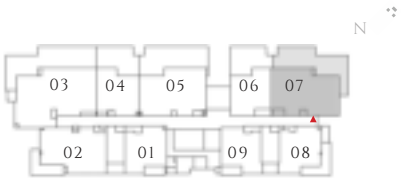

LEVEL 01

FLOOR PLAN 1. All dimensions are in imperial and metric, and measured from finish to finish excluding construction tolerances. 2. All materials, dimensions, and drawings are approximate only. 3. Information is subject to change without notice, at developer's absolute discretion. 4. Actual area may vary from the stated area. 5. Drawings not to scale. 6. All images used are for illustrative purposes only and do not represent the actual size, features, specifications, fittings, and furnishings. 7. The developer reserves the right to make revisions / alterations, at it's absolute discretion, without any liability whatsoever.

PARK LANE

DUBAI HILLS ESTATE

INTERIORS BY VIDA

2 BEDROOM

TYPE 1 A MIRROR | BUILDING 02B

UNITS 205, 305, 405, 505, 605, 705, 805, 905, 1005, 1105, 1205, 1405

SUITE AREA	963.59 SQFT	89.52 SQM
BALCONY AREA	76.85 SQFT	7.14 SQM
TOTAL AREA	1040.44 SQFT	96.66 SQM

UNITS 206,306, 406, 506, 606, 706, 806, 906, 1006, 1106, 1206

SUITE AREA	963.26 SQFT	89.49 SQM
BALCONY AREA	73.41 SQFT	6.82 SQM
TOTAL AREA	1036.67 SQFT	96.31 SQM



KEY SECTION

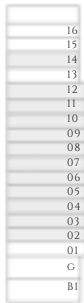

BUILDING 2B

KEY PLAN

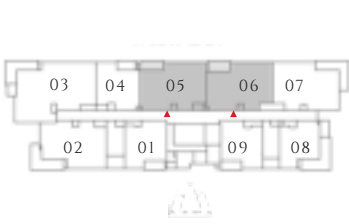

LEVEL 2-12

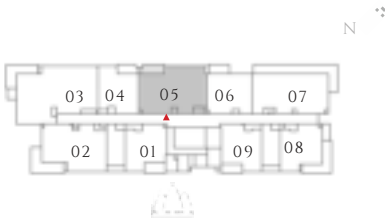

LEVEL 14

FLOOR PLAN 1. All dimensions are in imperial and metric, and measured from finish to finish excluding construction tolerances. 2. All materials, dimensions, and drawings are approximate only. 3. Information is subject to change without notice, at developer’s absolute discretion. 4. Actual area may vary from the stated area. 5. Drawings not to scale. 6. All images used are for illustrative purposes only and do not represent the actual size, features, specifications, fittings, and furnishings. 7. The developer reserves the right to make revisions / alterations, at it’s absolute discretion, without any liability whatsoever.

PARK LANE

DUBAI HILLS ESTATE

INTERIORS BY VIDA

2 BEDROOM

TYPE 1 A MIRROR | BUILDING 02B

UNITS 1305

SUITE AREA	963.37 SQFT	89.5 SQM
BALCONY AREA	78.15 SQFT	7.26 SQM
TOTAL AREA	1041.52 SQFT	96.76 SQM



KEY SECTION

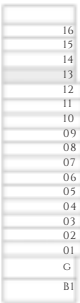

BUILDING 2B

KEY PLAN

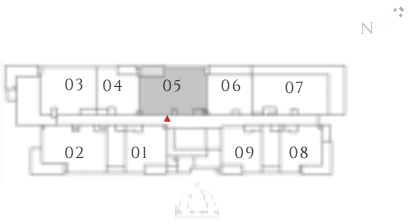

LEVEL 13

FLOOR PLAN 1. All dimensions are in imperial and metric, and measured from finish to finish excluding construction tolerances. 2. All materials, dimensions, and drawings are approximate only. 3. Information is subject to change without notice, at developer's absolute discretion. 4. Actual area may vary from the stated area. 5. Drawings not to scale. 6. All images used are for illustrative purposes only and do not represent the actual size, features, specifications, fittings, and furnishings. 7. The developer reserves the right to make revisions / alterations, at it's absolute discretion, without any liability whatsoever.

PARK LANE

DUBAI HILLS ESTATE

INTERIORS BY VIDA

2 BEDROOM

TYPE 1A.1 MIRROR | BUILDING 02B

UNITS 105

SUITE AREA	963.26 SQFT	89.49 SQM
BALCONY AREA	565 SQFT	52.49 SQM
TOTAL AREA	1528.26 SQFT	141.98 SQM



KEY SECTION

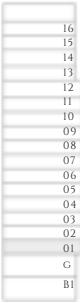

BUILDING 2B

KEY PLAN

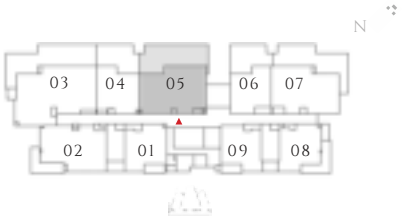

LEVEL 01

FLOOR PLAN 1. All dimensions are in imperial and metric, and measured from finish to finish excluding construction tolerances. 2. All materials, dimensions, and drawings are approximate only. 3. Information is subject to change without notice, at developer's absolute discretion. 4. Actual area may vary from the stated area. 5. Drawings not to scale. 6. All images used are for illustrative purposes only and do not represent the actual size, features, specifications, fittings, and furnishings. 7. The developer reserves the right to make revisions / alterations, at it's absolute discretion, without any liability whatsoever.

PARK LANE

DUBAI HILLS ESTATE

INTERIORS BY VIDA

2 BEDROOM

TYPE 2 MIRROR | BUILDING 02B

UNIT 1307

SUITE AREA	977.26 SQFT	90.79 SQM
BALCONY AREA	527.65 SQFT	49.02 SQM
TOTAL AREA	1504.9 SQFT	139.81 SQM



KEY SECTION

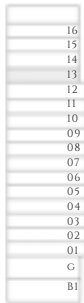

BUILDING 2B

KEY PLAN

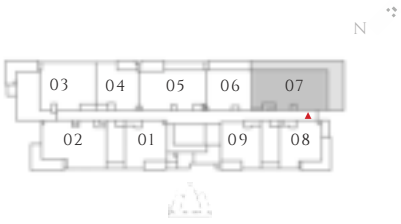

LEVEL 13

FLOOR PLAN 1. All dimensions are in imperial and metric, and measured from finish to finish excluding construction tolerances. 2. All materials, dimensions, and drawings are approximate only. 3. Information is subject to change without notice, at developer’s absolute discretion. 4. Actual area may vary from the stated area. 5. Drawings not to scale. 6. All images used are for illustrative purposes only and do not represent the actual size, features, specifications, fittings, and furnishings. 7. The developer reserves the right to make revisions / alterations, at it’s absolute discretion, without any liability whatsoever.

PARK LANE

DUBAI HILLS ESTATE

INTERIORS BY VIDA

2 BEDROOM

TYPE 2.1 MIRROR | BUILDING 02B

UNITS 1407, 1507, 1607

SUITE AREA	977.58 SQFT	90.82 SQM
BALCONY AREA	330.02 SQFT	30.66 SQM
TOTAL AREA	1307.6 SQFT	121.48 SQM



KEY SECTION

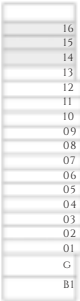

BUILDING 2B

KEY PLAN

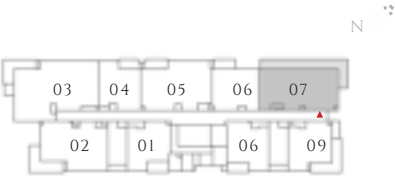

LEVEL 14

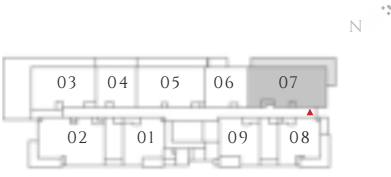

LEVEL 15



LEVEL 16

FLOOR PLAN 1. All dimensions are in imperial and metric, and measured from finish to finish excluding construction tolerances. 2. All materials, dimensions, and drawings are approximate only. 3. Information is subject to change without notice, at developer's absolute discretion. 4. Actual area may vary from the stated area. 5. Drawings not to scale. 6. All images used are for illustrative purposes only and do not represent the actual size, features, specifications, fittings, and furnishings. 7. The developer reserves the right to make revisions / alterations, at it's absolute discretion, without any liability whatsoever.

PARK LANE

DUBAI HILLS ESTATE

INTERIORS BY VIDA

2 BEDROOM

TYPE 3 MIRROR | BUILDING 02B

UNITS 1505

SUITE AREA	866.06 SQFT	80.46 SQM
BALCONY AREA	223.46 SQFT	20.76 SQM
TOTAL AREA	1089.52 SQFT	101.22 SQM



KEY SECTION

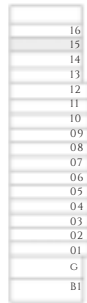

BUILDING 2B

KEY PLAN

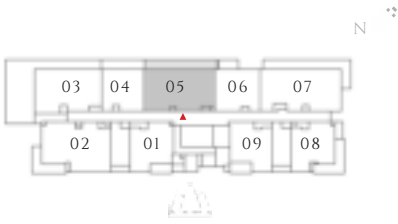

LEVEL 15

FLOOR PLAN 1. All dimensions are in imperial and metric, and measured from finish to finish excluding construction tolerances. 2. All materials, dimensions, and drawings are approximate only. 3. Information is subject to change without notice, at developer's absolute discretion. 4. Actual area may vary from the stated area. 5. Drawings not to scale. 6. All images used are for illustrative purposes only and do not represent the actual size, features, specifications, fittings, and furnishings. 7. The developer reserves the right to make revisions / alterations, at it's absolute discretion, without any liability whatsoever.

PARK LANE

DUBAI HILLS ESTATE

INTERIORS BY VIDA

2 BEDROOM

TYPE 3.1 MIRROR | BUILDING 02B

UNIT 1605

SUITE AREA	866.17 SQFT	80.47 SQM
BALCONY AREA	56.83 SQFT	5.28 SQM
TOTAL AREA	923.01 SQFT	85.75 SQM



KEY SECTION

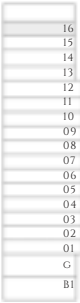

BUILDING 2B

KEY PLAN

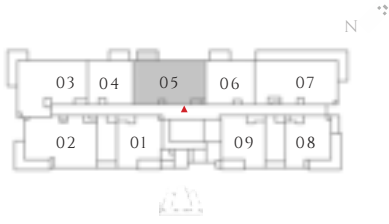

LEVEL 16

FLOOR PLAN 1. All dimensions are in imperial and metric, and measured from finish to finish excluding construction tolerances. 2. All materials, dimensions, and drawings are approximate only. 3. Information is subject to change without notice, at developer's absolute discretion. 4. Actual area may vary from the stated area. 5. Drawings not to scale. 6. All images used are for illustrative purposes only and do not represent the actual size, features, specifications, fittings, and furnishings. 7. The developer reserves the right to make revisions / alterations, at it's absolute discretion, without any liability whatsoever.

PARK LANE

DUBAI HILLS ESTATE

INTERIORS BY VIDA

2 BEDROOM

TYPE 4 MIRROR | BUILDING 02B

UNITS 1503

SUITE AREA	923.11 SQFT	85.76 SQM
BALCONY AREA	794.48 SQFT	73.81 SQM
TOTAL AREA	1717.6 SQFT	159.57 SQM



KEY SECTION

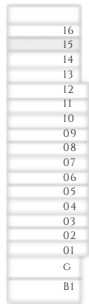

BUILDING 2B

KEY PLAN



LEVEL 15

FLOOR PLAN 1. All dimensions are in imperial and metric, and measured from finish to finish excluding construction tolerances. 2. All materials, dimensions, and drawings are approximate only. 3. Information is subject to change without notice, at developer's absolute discretion. 4. Actual area may vary from the stated area. 5. Drawings not to scale. 6. All images used are for illustrative purposes only and do not represent the actual size, features, specifications, fittings, and furnishings. 7. The developer reserves the right to make revisions / alterations, at it's absolute discretion, without any liability whatsoever.

PARK LANE

DUBAI HILLS ESTATE

INTERIORS BY VIDA

2 BEDROOM

TYPE 4.1 MIRROR | BUILDING 02B

UNIT 1603

SUITE AREA	922.36 SQFT	85.69 SQM
BALCONY AREA	134.33 SQFT	12.48 SQM
TOTAL AREA	1056.69 SQFT	98.17 SQM



KEY SECTION

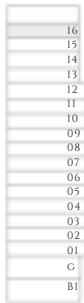

BUILDING 2B

KEY PLAN



LEVEL 16

FLOOR PLAN 1. All dimensions are in imperial and metric, and measured from finish to finish excluding construction tolerances. 2. All materials, dimensions, and drawings are approximate only. 3. Information is subject to change without notice, at developer's absolute discretion. 4. Actual area may vary from the stated area. 5. Drawings not to scale. 6. All images used are for illustrative purposes only and do not represent the actual size, features, specifications, fittings, and furnishings. 7. The developer reserves the right to make revisions / alterations, at it's absolute discretion, without any liability whatsoever.

PARK LANE

DUBAI HILLS ESTATE

INTERIORS BY VIDA

3 BEDROOM

TYPE 1 MIRROR | BUILDING 02B

UNIT 203, 303, 403, 503, 603, 703, 803, 903, 1003, 1103, 1403

SUITE AREA	1368.85 SQFT	127.17 SQM
BALCONY AREA	154.79 SQFT	14.38 SQM
TOTAL AREA	1523.63 SQFT	141.55 SQM

UNITS 1203, 1303

SUITE AREA	1368.85 SQFT	127.17 SQM
BALCONY AREA	155.22 SQFT	14.42 SQM
TOTAL AREA	1524.06 SQFT	141.59 SQM



KEY SECTION

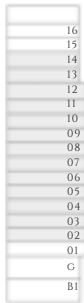

BUILDING 2B

KEY PLAN

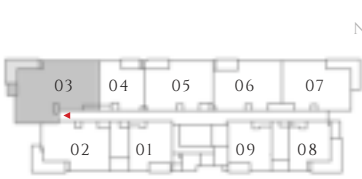

LEVEL 2-12

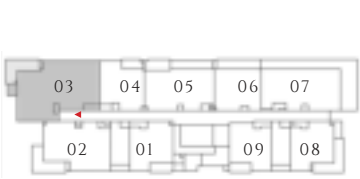

LEVEL 13

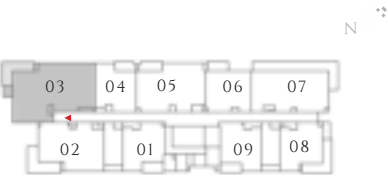

LEVEL 14

FLOOR PLAN 1. All dimensions are in imperial and metric, and measured from finish to finish excluding construction tolerances. 2. All materials, dimensions, and drawings are approximate only. 3. Information is subject to change without notice, at developer's absolute discretion. 4. Actual area may vary from the stated area. 5. Drawings not to scale. 6. All images used are for illustrative purposes only and do not represent the actual size, features, specifications, fittings, and furnishings. 7. The developer reserves the right to make revisions / alterations, at it's absolute discretion, without any liability whatsoever.

PARK LANE

DUBAI HILLS ESTATE

INTERIORS BY VIDA

3 BEDROOM

TYPE 1.1 MIRROR | BUILDING 02B

UNIT 103

SUITE AREA	1368.74 SQFT	127.16 SQM
BALCONY AREA	625.81 SQFT	58.14 SQM
TOTAL AREA	1994.55 SQFT	185.3 SQM



KEY SECTION

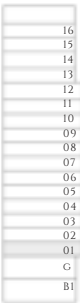

BUILDING 2B

KEY PLAN

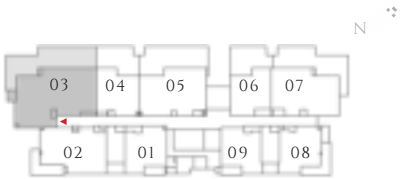

LEVEL 01

FLOOR PLAN 1. All dimensions are in imperial and metric, and measured from finish to finish excluding construction tolerances. 2. All materials, dimensions, and drawings are approximate only. 3. Information is subject to change without notice, at developer's absolute discretion. 4. Actual area may vary from the stated area. 5. Drawings not to scale. 6. All images used are for illustrative purposes only and do not represent the actual size, features, specifications, fittings, and furnishings. 7. The developer reserves the right to make revisions / alterations, at it's absolute discretion, without any liability whatsoever.

PARK LANE

DUBAI HILLS ESTATE

— INTERIORS BY VIDA —

FLOOR PLAN - PODIUM

EMAAR

PARK LANE

DUBAI HILLS ESTATE

— INTERIORS BY VIDA —

PODIUM

3BHK TYPE 1.2 | PODIUM BUILDING

UNITS G-01

SUITE AREA	1390.7 SQFT	129.2 SQM
BALCONY AREA	812.78 SQFT	75.51 SQM
TOTAL AREA	2203.48 SQFT	204.71 SQM



KEY PLAN

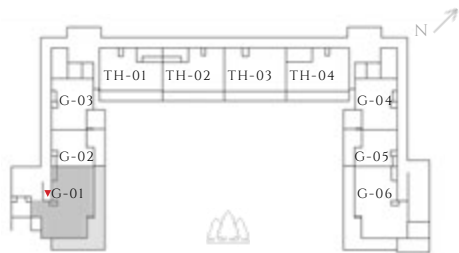

GROUND FLOOR

FLOOR PLAN 1. All dimensions are in imperial and metric, and measured from finish to finish excluding construction tolerances. 2. All materials, dimensions, and drawings are approximate only. 3. Information is subject to change without notice, at developer’s absolute discretion. 4. Actual area may vary from the stated area. 5. Drawings not to scale. 6. All images used are for illustrative purposes only and do not represent the actual size, features, specifications, fittings, and furnishings. 7. The developer reserves the right to make revisions / alterations, at it’s absolute discretion, without any liability whatsoever.

PARK LANE

DUBAI HILLS ESTATE

— INTERIORS BY VIDA —

PODIUM

3BHK TYPE 1.2 MIRROR | PODIUM BUILDING

UNITS G-06

SUITE AREA	1392.96 SQFT	129.41 SQM
BALCONY AREA	749.28 SQFT	69.61 SQM
TOTAL AREA	2142.23 SQFT	199.02 SQM



KEY PLAN

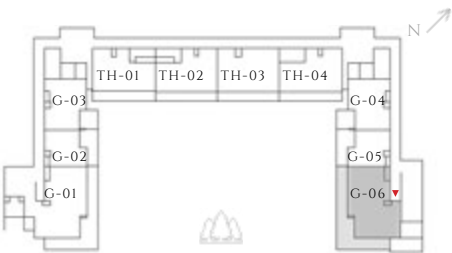

GROUND FLOOR

FLOOR PLAN 1. All dimensions are in imperial and metric, and measured from finish to finish excluding construction tolerances. 2. All materials, dimensions, and drawings are approximate only. 3. Information is subject to change without notice, at developer’s absolute discretion. 4. Actual area may vary from the stated area. 5. Drawings not to scale. 6. All images used are for illustrative purposes only and do not represent the actual size, features, specifications, fittings, and furnishings. 7. The developer reserves the right to make revisions / alterations, at it’s absolute discretion, without any liability whatsoever.

PARK LANE

DUBAI HILLS ESTATE

— INTERIORS BY VIDA —

PODIUM

1BHK TYPE 1.3 | PODIUM BUILDING

UNITS G-02

SUITE AREA	594.06 SQFT	55.19 SQM
BALCONY AREA	258.01 SQFT	23.97 SQM
TOTAL AREA	852.07 SQFT	79.16 SQM



KEY PLAN

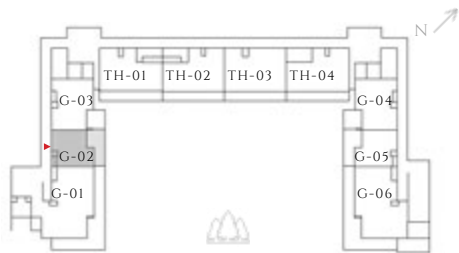

GROUND FLOOR

FLOOR PLAN 1. All dimensions are in imperial and metric, and measured from finish to finish excluding construction tolerances. 2. All materials, dimensions, and drawings are approximate only. 3. Information is subject to change without notice, at developer’s absolute discretion. 4. Actual area may vary from the stated area. 5. Drawings not to scale. 6. All images used are for illustrative purposes only and do not represent the actual size, features, specifications, fittings, and furnishings. 7. The developer reserves the right to make revisions / alterations, at it’s absolute discretion, without any liability whatsoever.

PARK LANE

DUBAI HILLS ESTATE

— INTERIORS BY VIDA —

PODIUM

1BHK TYPE 1.3 MIRROR | PODIUM BUILDING

UNITS G-05

SUITE AREA	592.12 SQFT	55.01 SQM
BALCONY AREA	259.95 SQFT	24.15 SQM
TOTAL AREA	852.07 SQFT	79.16 SQM



KEY PLAN

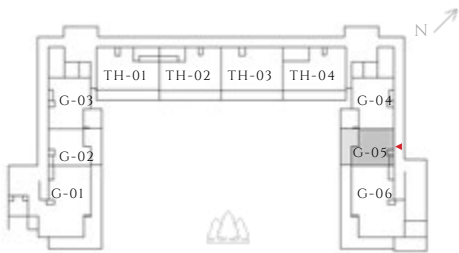

GROUND FLOOR

FLOOR PLAN 1. All dimensions are in imperial and metric, and measured from finish to finish excluding construction tolerances. 2. All materials, dimensions, and drawings are approximate only. 3. Information is subject to change without notice, at developer's absolute discretion. 4. Actual area may vary from the stated area. 5. Drawings not to scale. 6. All images used are for illustrative purposes only and do not represent the actual size, features, specifications, fittings, and furnishings. 7. The developer reserves the right to make revisions / alterations, at it's absolute discretion, without any liability whatsoever.

PARK LANE

DUBAI HILLS ESTATE

— INTERIORS BY VIDA —

PODIUM

1BHK TYPE 1.4 | PODIUM BUILDING

UNITS G-03

SUITE AREA	592.02 SQFT	55 SQM
BALCONY AREA	167.92 SQFT	15.6 SQM
TOTAL AREA	759.93 SQFT	70.6 SQM



KEY PLAN

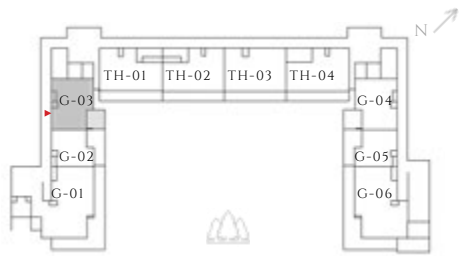

GROUND FLOOR

FLOOR PLAN 1. All dimensions are in imperial and metric, and measured from finish to finish excluding construction tolerances. 2. All materials, dimensions, and drawings are approximate only. 3. Information is subject to change without notice, at developer’s absolute discretion. 4. Actual area may vary from the stated area. 5. Drawings not to scale. 6. All images used are for illustrative purposes only and do not represent the actual size, features, specifications, fittings, and furnishings. 7. The developer reserves the right to make revisions / alterations, at it’s absolute discretion, without any liability whatsoever.

PARK LANE

DUBAI HILLS ESTATE

— INTERIORS BY VIDA —

PODIUM

1BHK TYPE 1.4 MIRROR | PODIUM BUILDING

UNITS G-04

SUITE AREA	589.86 SQFT	54.8 SQM
BALCONY AREA	168.13 SQFT	15.62 SQM
TOTAL AREA	757.99 SQFT	70.42 SQM



KEY PLAN

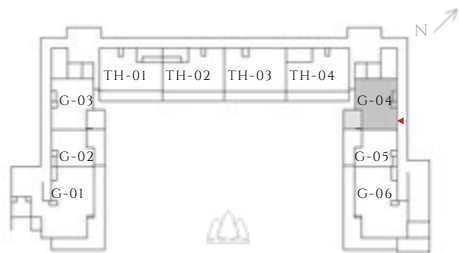

GROUND FLOOR

FLOOR PLAN 1. All dimensions are in imperial and metric, and measured from finish to finish excluding construction tolerances. 2. All materials, dimensions, and drawings are approximate only. 3. Information is subject to change without notice, at developer’s absolute discretion. 4. Actual area may vary from the stated area. 5. Drawings not to scale. 6. All images used are for illustrative purposes only and do not represent the actual size, features, specifications, fittings, and furnishings. 7. The developer reserves the right to make revisions / alterations, at it’s absolute discretion, without any liability whatsoever.

PARK LANE

DUBAI HILLS ESTATE

— INTERIORS BY VIDA —

TOWNHOUSE

TOWNHOUSE TYPE 1| PODIUM BUILDING

UNITS TH-01

SUITE AREA	2294.97 SQFT	213.21 SQM
BALCONY AREA	307.42 SQFT	28.56 SQM
TOTAL AREA	2602.39 SQFT	241.77 SQM

UNITS TH-03

SUITE AREA	2284.96 SQFT	212.28 SQM
BALCONY AREA	302.57 SQFT	28.11 SQM
TOTAL AREA	2587.54 SQFT	240.39 SQM



GROUND FLOOR



FIRST FLOOR

KEY PLAN

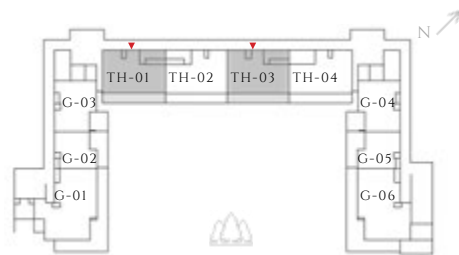

GROUND FLOOR

FLOOR PLAN 1. All dimensions are in imperial and metric, and measured from finish to finish excluding construction tolerances. 2. All materials, dimensions, and drawings are approximate only. 3. Information is subject to change without notice, at developer's absolute discretion. 4. Actual area may vary from the stated area. 5. Drawings not to scale. 6. All images used are for illustrative purposes only and do not represent the actual size, features, specifications, fittings, and furnishings. 7. The developer reserves the right to make revisions / alterations, at it's absolute discretion, without any liability whatsoever.

PARK LANE

DUBAI HILLS ESTATE

— INTERIORS BY VIDA —

TOWNHOUSE

TOWNHOUSE TYPE 1 MIRROR| PODIUM BUILDING

UNITS TH-02

SUITE AREA	2282.92 SQFT	212.09 SQM
BALCONY AREA	305.05 SQFT	28.34 SQM
TOTAL AREA	2587.97 SQFT	240.43 SQM

UNITS TH-04

SUITE AREA	2290.78 SQFT	212.82 SQM
BALCONY AREA	307.42 SQFT	28.56 SQM
TOTAL AREA	2598.19 SQFT	241.38 SQM



GROUND FLOOR



FIRST FLOOR

KEY PLAN

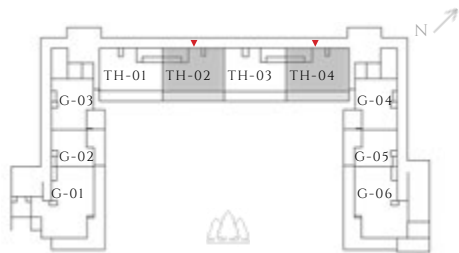

GROUND FLOOR

FLOOR PLAN 1. All dimensions are in imperial and metric, and measured from finish to finish excluding construction tolerances. 2. All materials, dimensions, and drawings are approximate only. 3. Information is subject to change without notice, at developer's absolute discretion. 4. Actual area may vary from the stated area. 5. Drawings not to scale. 6. All images used are for illustrative purposes only and do not represent the actual size, features, specifications, fittings, and furnishings. 7. The developer reserves the right to make revisions / alterations, at it's absolute discretion, without any liability whatsoever.



FOR BOOKING & DETAILS

London Office

The Suite: A5-03 Room 03
Floor 5 Block A
The Vista Centre, 50 Salisbury
Road
Hounslow London TW4 6JQ

+44 203 371 1111

Dubai Office

1405 Regal Tower Business Bay
Dubai-UAE

+971 52 742 3439

www.idnrealtors.ae